

# BACKLYTE INSTALLATION GUIDE

Tech Support: 212.629.6830



Our US team is in place to answer all of your product questions and help with installations.



**U.S. 24-HR TECHNICAL SUPPORT**

(+1) 212 629 6830 \*301  
[Tech@GENLEDBrands.com](mailto:Tech@GENLEDBrands.com)



**U.S. PRICING & SALES SUPPORT**

(+1) 212 629 6830 \*300  
[Sales-US@GENLEDBrands.com](mailto:Sales-US@GENLEDBrands.com)



**U.S. CUSTOMER SERVICE**

(+1) 212 629 6830 \*304  
[CustomerService@GENLEDBrands.com](mailto:CustomerService@GENLEDBrands.com)



## BACKLYTE INSTALLATION

**\*Note** - This product is frameless and is designed to be installed behind translucent products or built into a frame. Because it is a custom product and each installation is different, we do not supply mounting for this product. It can be used with mirror or Z-Clips, or built into a custom frame. The following guide is an example of an installation with a custom frame, by others, and BackLyte.



1. Prepare custom frame. Drill all necessary holes for wire feeds and fastener locations. Mount the frame to the desired surface. Insert the backlyte into the custom frame and make all necessary electrical connections.



2. Use felt or other non-damaging shim material to fill any gaps between the frame and backlyte to keep it secure.

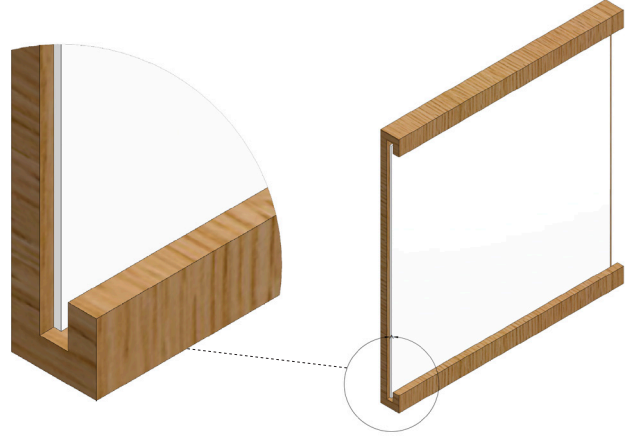

3. Make sure to enclose the custom frame to ensure the backlyte stays in place. Installation complete.

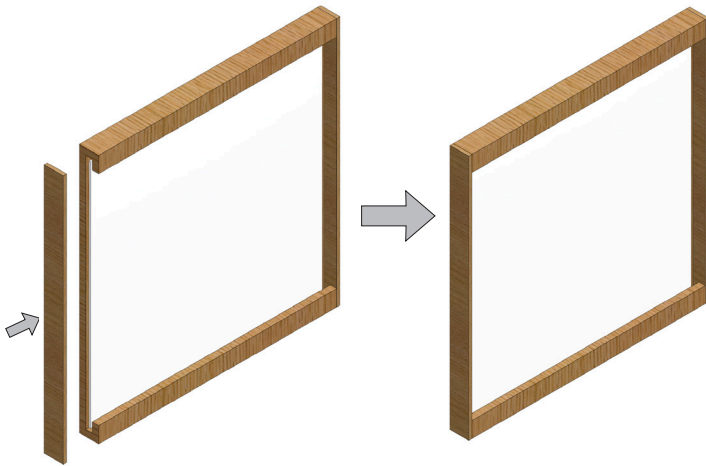



## BACKLYTE Z-CLIP INSTALLATION

**\*Note** - This product is frameless and is designed to be installed behind translucent products or built into a frame. Because it is a custom product and each installation is different, we do not supply mounting for this product. It can be used with mirror or Z-Clips, or built into a custom frame. The following guide is an example of an installation with a custom frame, by others, and BackLyte.



1. Prepare custom frame. Drill all necessary holes for wire feeds and fastener locations and mount the first Z-Clip to the back surface of the frame.

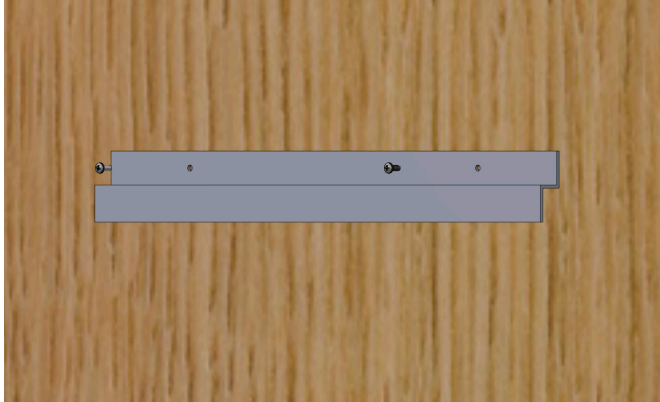

2. Repeat the same steps in (1.) to mount the second Z-Clip to the desired mounting surface.

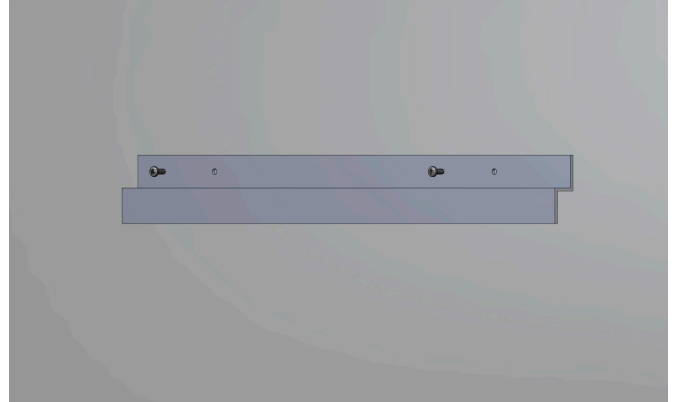

3. Align the custom frame such that the Z-Clips align and the frame is secured to the mounting surface.

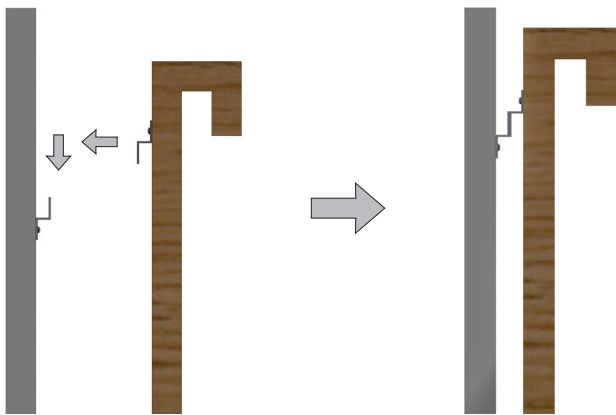

4. Insert the BackLyte into the custom frame and make all necessary electrical connections.



5. Use felt or other non-damaging shim material to fill any gaps between the frame and backlyte to keep it secure.

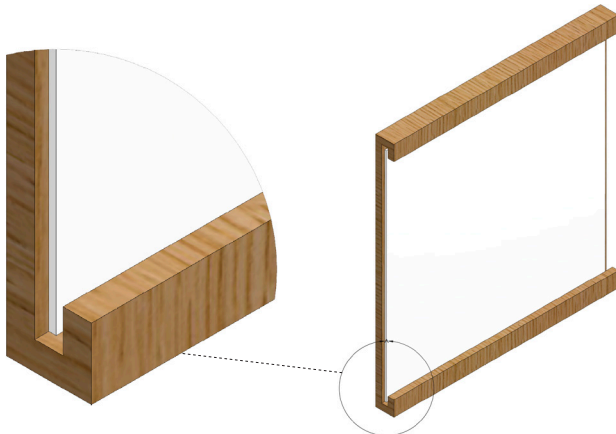

6. Make sure to enclose the custom frame to ensure the backlyte stays in place. Installation complete.

