

***Note** - This product is frameless and is designed to be installed behind translucent products or built into a frame. Because it is a custom product and each installation is different, we do not supply mounting for this product. It can be used with mirror or Z-Clips, or built into a custom frame. The following guide is an example of an installation with a custom frame, by others, and BackLyte.

BACKLYTE The depth of the Z-Clip or custom frame needs to be greater than the thickness of BackLyte (0.52 in. / 13.2 mm).

1. Prepare custom frame. Drill all necessary holes for wire feeds and fastener locations. Mount the frame to the desired surface. Insert the BackLyte into the custom frame and make all necessary electrical connections.

2. Use felt or other non-damaging shim material to fill any gaps between the frame and BackLyte to keep it secure.

3. Make sure to enclose the custom frame to ensure the BackLyte stays in place. Installation complete.

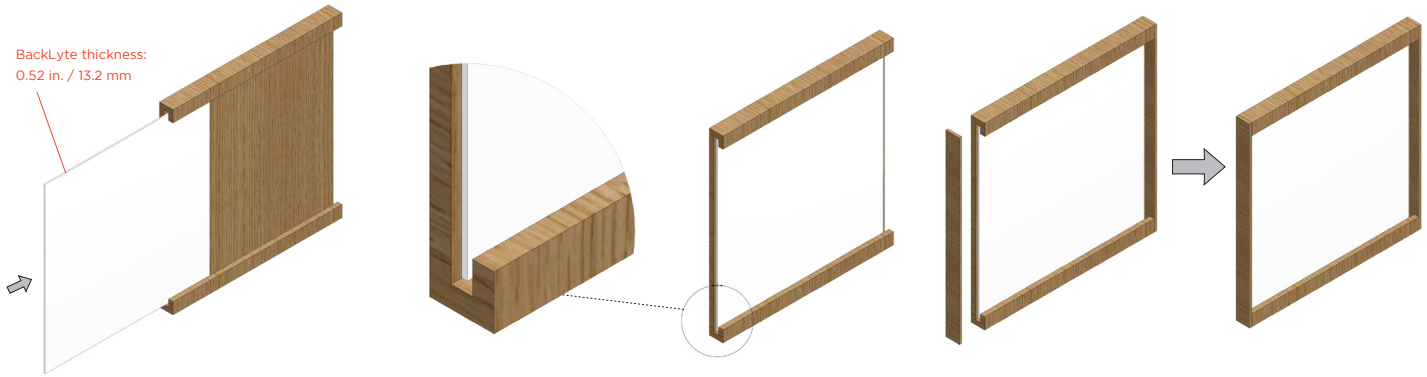

Z-CLIP The depth of the Z-Clip or custom frame needs to be greater than the thickness of BackLyte (0.52 in. / 13.2 mm).

1. Prepare custom frame. Drill all necessary holes for wire feeds and fastener locations and mount the first Z-Clip to the back surface of the frame.

2. Repeat the same steps in (1.) to mount the second Z-Clip to the desired mounting surface.

3. Align the custom frame such that the Z-Clips align and the frame is secured to the mounting surface.

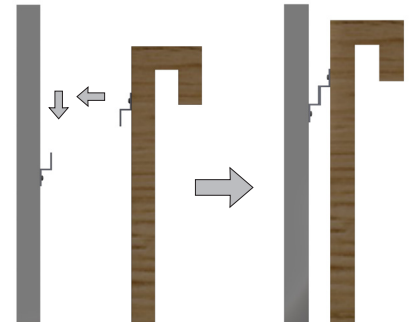
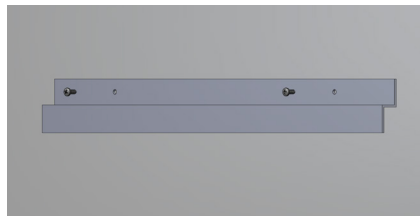
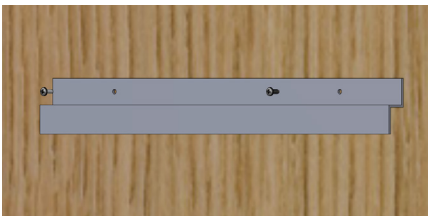

4. Insert the BackLyte into the custom frame and make all necessary electrical connections.

5. Use felt or other non-damaging shim material to fill any gaps between the frame and BackLyte to keep it secure.

6. Make sure to enclose the custom frame to ensure the BackLyte stays in place. Installation complete.

