

WITH STAINLESS STEEL MOUNTING CLIPS

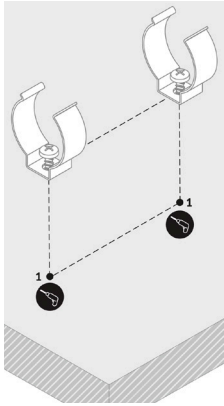

1. Measure, align and mark locations for mounting clips.

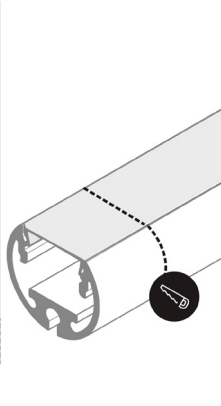

2. Cut channel and lens to desired (equal) lengths.

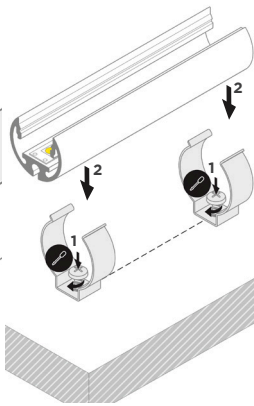

3. Affix mounting clips with fastener. Attach fixture on mounting clips.

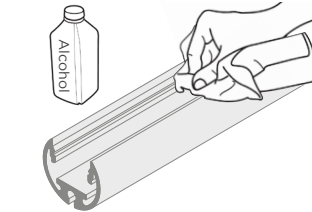

4. Clean the inside surface of the channel of dust & debris with rubbing alcohol. Dry.

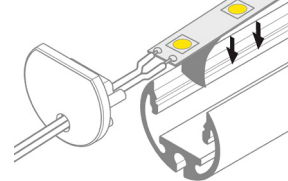

5. Apply RibbonLyte and make all electrical connections.

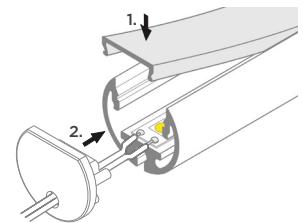

6. Click or slide lens into place. Apply end caps to complete installation.

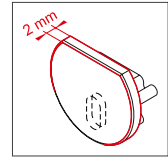

NOTE: There is a marked space in each end cap to drill for electrical connections. Each end cap adds 2 mm to length of fixture.

WITH ROD MOUNT

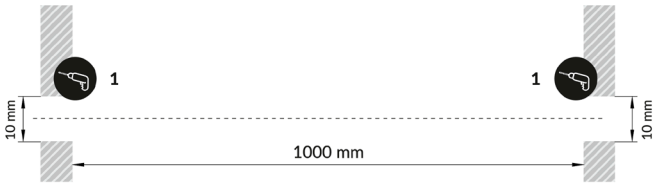

1. Measure, align and mark locations for rod mount. Cut 10 mm round groove in mounting surfaces.

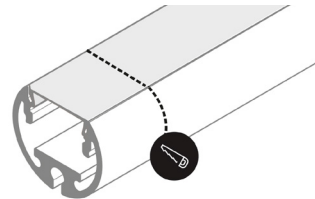

2. Cut channel and lens 20 mm shorter than distance between mounting surfaces.

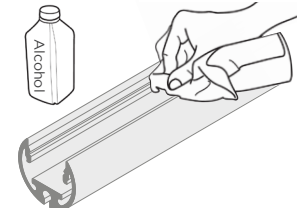

4. Clean the inside surface of the channel of dust & debris with rubbing alcohol. Dry.

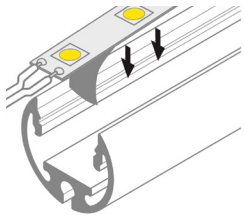

4. Apply RibbonLyte and make all electrical connections.

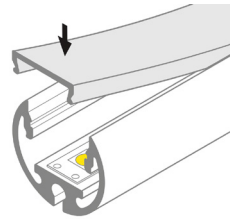

5. Click or slide lens into place.

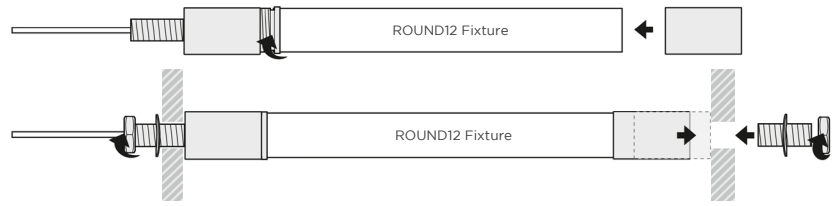

6. Attach threaded end to power side of fixture, and then attach threaded end to non-power side of fixture. Adjust threads to fit. Fixture installation complete.

WITH RING HOLDER

1. Measure, align and mark mounting surfaces for application (may require more depth on power supply side). Cut 22 mm round groove about 6 mm deep in mounting surfaces. Affix ring holders near ends on either side.

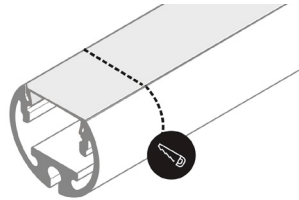
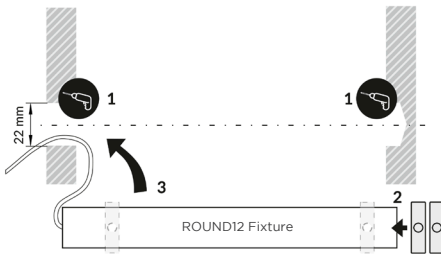

2. Cut channel and lens 20 mm shorter than distance between mounting surfaces.

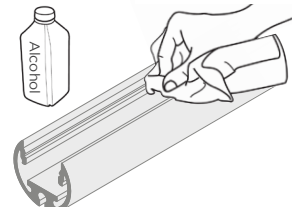

4. Clean the inside surface of the channel of dust & debris with rubbing alcohol. Dry.

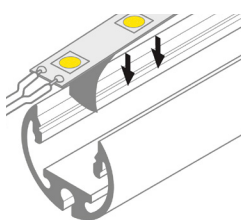

4. Apply RibbonLyte and make all electrical connections.

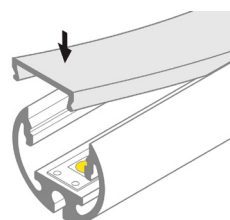

5. Click or slide lens into place.

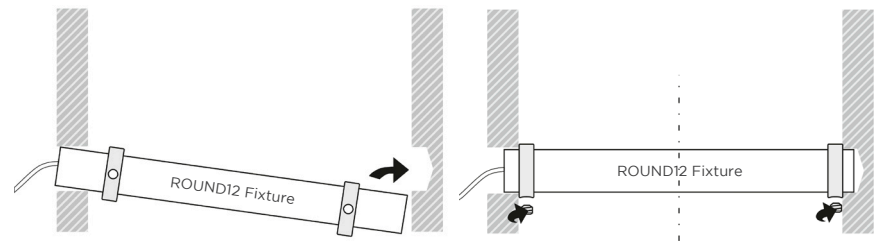

6. Slide fixture into round recessed groove on power side first, then on non-power side.

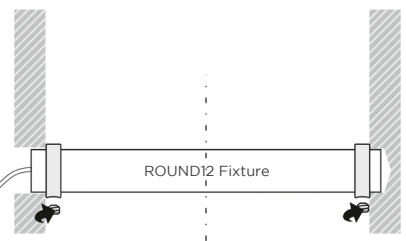

7. Align to center and adjust ring holders flush to mounting surface. Fixture installation complete.