

DIMMABLE INTEGRATED DRIVERS

The Dimmable Integrated Driver from AmbienTech provides unbeatable flicker-free dimming down to 0.1% for Variable White and Warm-Dim applications. Controlled by an app or wall switch with a wireless signal and available in 12VDC and 24VDC output, the Dimmable Integrated Driver junction box is a UL Listed Class 2 driver with separate input and output compartments and three knockouts for easy installation.

- Dimming for Variable White and Warm-Dim applications
- Controlled by wall switch with wireless signal
- Single switch can control multiple LED drivers
- Flicker-free dimming down to 0.1%
- Complies with Title 24 dimming requirements
- Current limit overload protection
- No minimum load requirement
- 12VDC or 24VDC output

Applications:

Commercial
Entertainment
Healthcare

Hospitality
Museums
Public Spaces

Residential
Retail

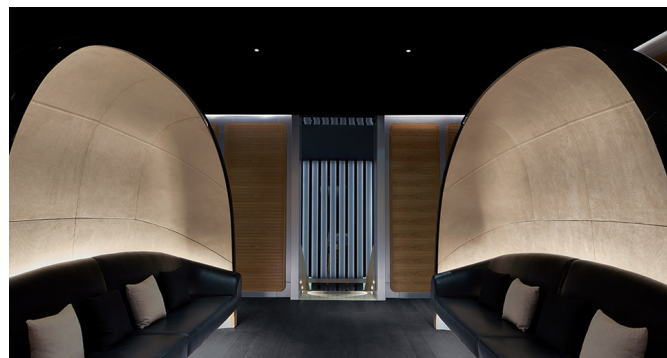

ORDERING GUIDE

Category	Voltage	Wattage	Input Voltage
DRVRF	24		120
DRVRF - Dimmable Integrated Driver	24 - 24 VDC	60 - 60W 90 - 90W	120 - 120 VAC

COMPATIBLE DIMMERS & DIMMING CONTROL MODULE

VARIABLE WHITE DIMMER (PART #: RFDIMVWWH / RFDIMVWBK)

DIMENSIONS	FEATURES
 <p>Width: 2.9 in. (74.5 mm) Length: 4.7 in. (119 mm) Depth: 1.6 in. (40.6 mm)</p>	<ul style="list-style-type: none"> - Dimming for Variable White applications - Wall switch with wireless signal - Flicker-free dimming down to 0.1% - Offers App and voice control - Complies with Title 24 dimming requirements

WARM DIM DIMMER (PART #: RFDIMWDWH / RFDIMWDBK)

DIMENSIONS	FEATURES
 <p>Width: 2.9 in. (74.5 mm) Length: 4.7 in. (119 mm) Depth: 1.6 in. (40.6 mm)</p>	<ul style="list-style-type: none"> - Dimming for Warm-Dim applications - Wall switch with wireless signal - Flicker-free dimming down to 0.1% - On-site programmable dimming curve - Complies with Title 24 dimming requirements

MAX LENGTH BETWEEN DRIVER & RIBBONLYTE AT FULL LOAD

Wattages	60		90	
Wire Gauge	Feet	Meters	Feet	Meters
24 AWG / 0.25 mm ²	9	2.74	5.5	1.68
22 AWG / 0.34 mm ²	14	4.27	9	2.74
20 AWG / 0.5 mm ²	23	7.01	14	4.27
18 AWG / 0.75 mm ²	37	11.28	23	7.01
16 AWG / 15 mm ²	60	18.29	37	11.28
14 AWG / 2.5 mm ²	95	28.96	59	17.99
12 AWG / 4 mm ²	151	46.04	94	28.66
10 AWG / 6 mm ²	240	73.17	150	45.73
8 AWG / 10 mm ²	381	116.16	239	72.87

SPECIFICATIONS

DIMMABLE INTEGRATED DRIVERS		
Max Power	60 W Part No: DRVRF2460120	90 W Part No: DRVRF2490120
Rated Voltage (DC)	24 VDC	24 VDC
No Load Voltage	25.2 VDC	25.2 VDC
Input Voltage (VAC)	120 VAC +/- 10%	120 VAC +/- 10%
Voltage Ripple & Noise (Max)	300 mV (Vp-p)	300 mV (Vp-p)
Power Factor	PF>0.96	
Rated Current	2.5 A	3.75 A
Rated Power	60 W	
Input Frequency	60Hz	
Efficiency (max load)	87%	89%
Max Input Current	0.95 A	
Safety Standards	Conforms to UL STD. 1310, Certified CSA, STD. C22.2 No. 223	Conforms to UL STD. 1310, Certified CSA, STD. C22.2 No. 223
Material/Finish	Sheet metal/powder coat	Sheet metal/powder coat
IP Rating	IP23 (indoor)	IP23 (indoor)
Control Protocol	RF (auto pairing)	RF (auto pairing)
Dimming Range	100% -0.1%	100% -0.1%
Dim-to-Off	Yes	Yes
Dimming Method	PWM (2400Hz)	PWM (2400Hz)
Dimming Curve	Logarithmic (Default)	Logarithmic (Default)
Dimensions	8.4 in. x 4.1 in. x 1.5 in. (213 mm x 104 mm x 38 mm)	8.4 in. x 4.1 in. x 1.5 in. (213 mm x 104 mm x 38 mm)
Weight	3.13 lbs	

DIMENSION DRAWINGS

60 W / 96 W Drivers

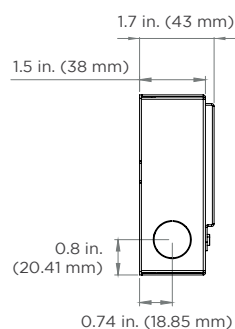
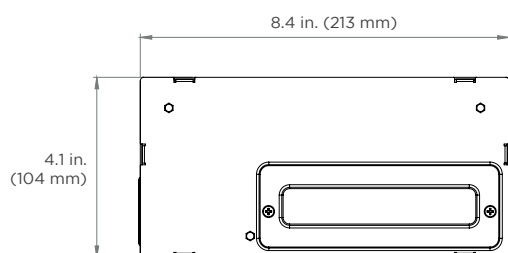

Wall Bracket

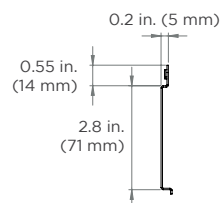
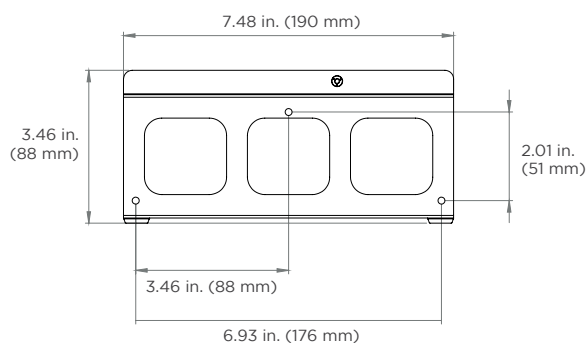

WIRING DIAGRAMS

VARIABLE WHITE

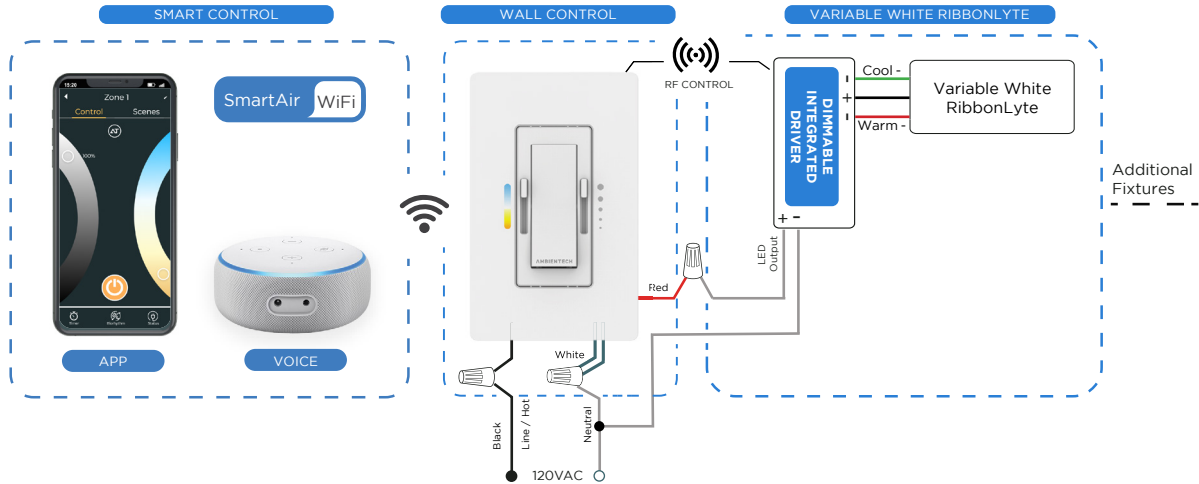

WARM DIM

