

### FLEXIBLE BACKLYTE ADDRESSABLE SHEET

The Flexible BackLyte Addressable Sheet lets you program and control individual pixels for precision lighting effects. Each 12.6 x 18.9 in. (320 x 480 mm) sheet includes 96 RGB pixels. The sheet is only 0.08 in. (2 mm) thick. Trim, bend and daisy chain each Flexible BackLyte Addressable Sheet to create custom shapes. Cut around any obstacles! Use with incredibly simple SPI (Serial Peripheral Interface) controls for amazing color changing effects.

- Flexible 12.6 x 18.9 in. (320 x 480 mm) sheet
- 48 cuttable rectangles
- 624 lm/sheet (all on)
- 96 RGB pixels per sheet spaced at 1.6 in. (40 mm)
- Program each individual LED pixel
- Uses SPI controls
- 4 in. (100 mm) min. bending radius (width)
- 2 in. (50 mm) min. bending radius (length)
- 12V
- Daisy chain up to 10 full sheets with jumpers
- IP20 for indoor use
- 5-year warranty

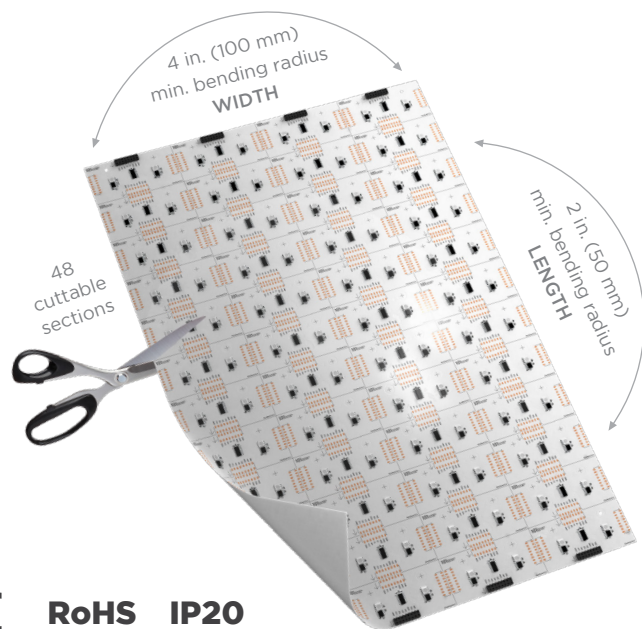

### ORDERING GUIDE

Category	Voltage	IP Rating	Wattage	Color or Color Temperature
<b>FBLADD</b>	<b>12</b>	<b>20</b>	<b>24</b>	<b>RGB</b>
FBLADD - Flexible Backlyte Addressable	12 - 12V DC	20 - IP20	24 - 24 W	RGB - Red, Green, Blue

### AVAILABLE COLORS



RGB

### ACCESSORIES:

1. Jumper  
ADDBLJUMP
2. Lead PCB  
ADDBLHEADER
3. Lead Cable  
ADDBLCBLFB1000 (3 ft 3.3 in. | 1 m)  
ADDBLCBLFB2000 (6 ft 6.7 in. | 2 m)  
ADDBLCBLFB3000 (9 ft 10 in. | 3 m)
4. Easy Connect  
DIGIEC

### SPECIFICATIONS

Operating Voltage	12V DC
Power Consumption	24 W
IC Code	16-bit (Default) GS8208
Luminous Efficacy	26 lm/W
Beam Angle	120°
LEDs per sheet	96
LED spacing	1.57 in. (40 mm)
Pixels per fixture	96
Color Temperature	RGB
Luminous Flux	624 lm per sheet
Minimum Bend Radius	Length: 2 in. (50 mm) Width: 4 in. (100 mm)
Protection Rating	IP20
Storage Temperature	-40° F to 176° (-40° C to 80° C)
Operating Temperature	-22° F to 140° (-30° C to 60° C)
Lamp Life	50,000 Hours
Dimensions (LxWxH)	18.89 x 12.59 x 0.078 in. (480 x 320 x 2 mm)
Warranty	5 Years

Acolyte does not warrant or represent that the information is free from errors or omission. The information may change without notice and Acolyte is not in any way liable for the accuracy of any information printed and stored or in any way interpreted or used.

DIMENSIONS

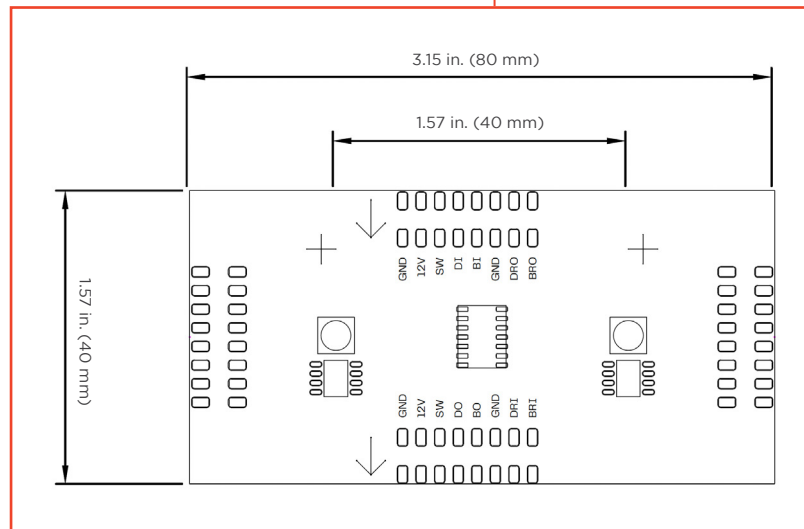

**LEADER PCB**

Part #: ADDBLHEADER

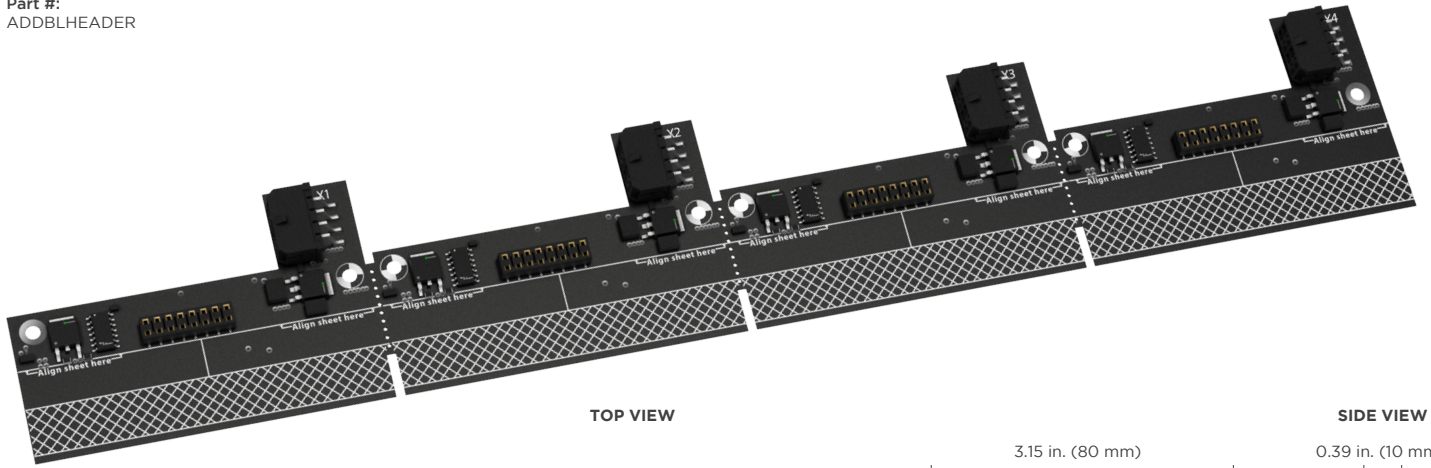

TOP VIEW

SIDE VIEW

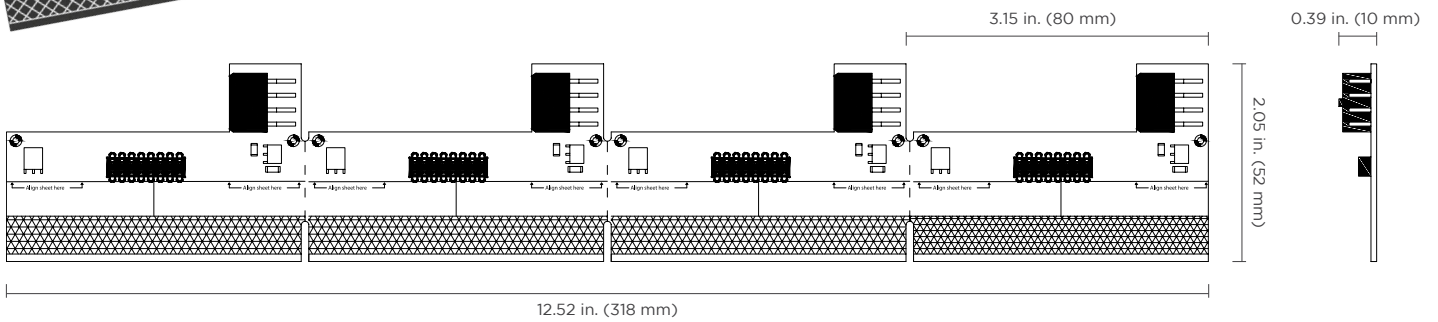

**JUMPER**

Part #: ADDBLJUMP



TOP VIEW

SIDE VIEW

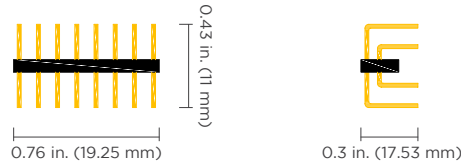

**ASSEMBLED VIEW**

Flexible BackLyte Addressable Sheet

Leader PCB

Jumper

Connect Flexible BackLyte Addressable Sheet to the Leader PCB with jumpers

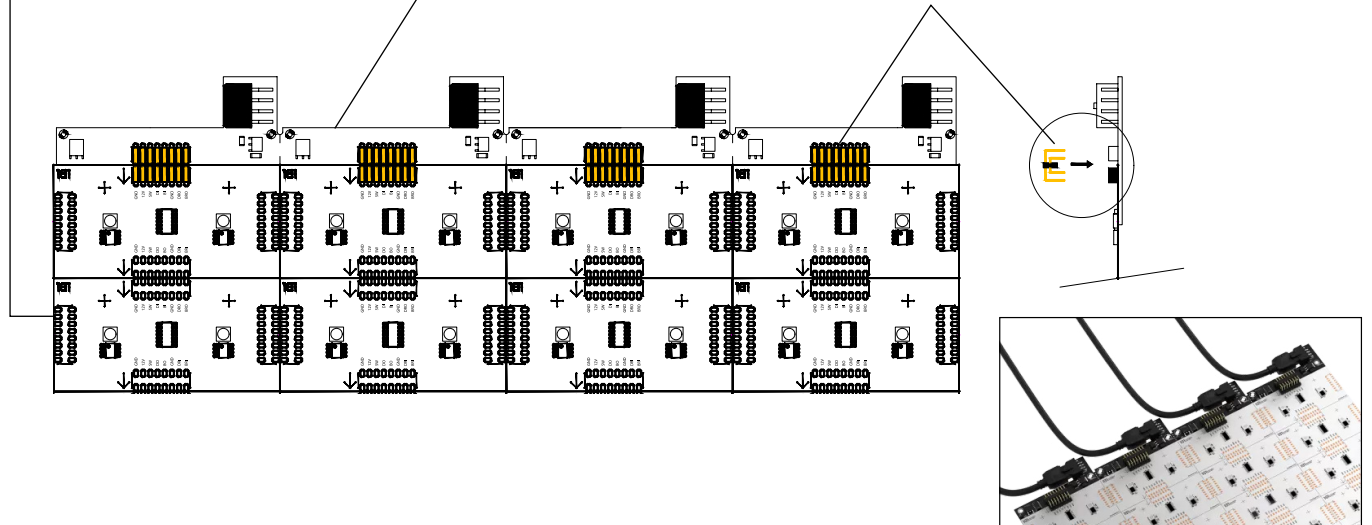

**LEADER CABLE (PUSH-IN TERMINAL TO FEMALE CONNECTOR)**

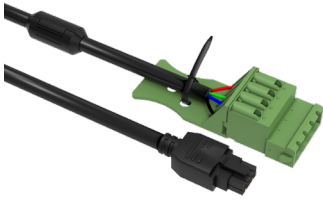

**Part #:**  
 ADDBLCLFB1000 (3 ft 3.3 in. | 1 m)  
 ADDBLCLFB2000 (6 ft 6.7 in. | 2 m)  
 ADDBLCLFB3000 (9 ft 10 in. | 3 m)

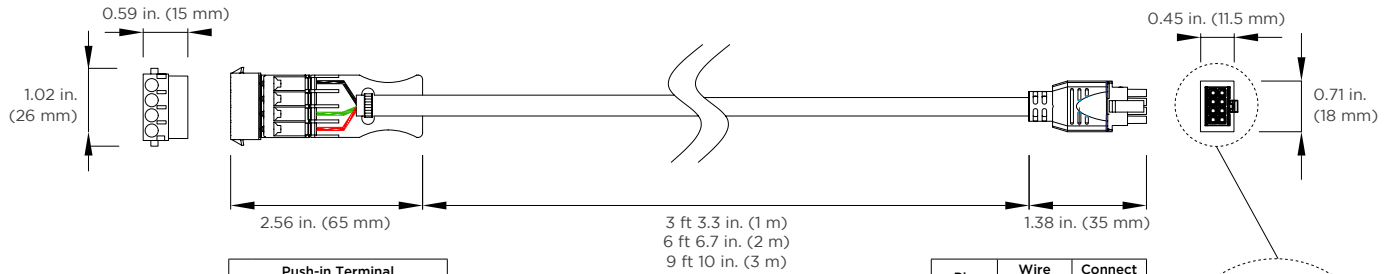

Push-in Terminal		
1	Red	V +
2	Green	Data
3	Not used	Not used
4	Black	GND

Pin	Wire Color	Connect To
1	Black	-
2	Orange	-
3	Red	-
4	Blue	SPI signal
5	White	+
6	Yellow	-
7	Green	+
8	Grey	+

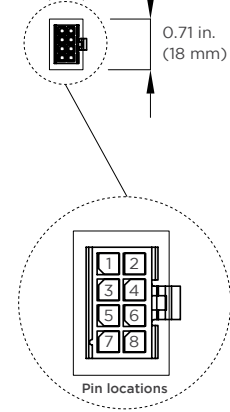

**EASY CONNECT**

Easy Connect is a plug and play connector that joins your C4 controller and power supply with your LEDs. No complex wiring required. Connect your power supply on one side and the input cable on the other.

**Part #:**  
DIGIEC

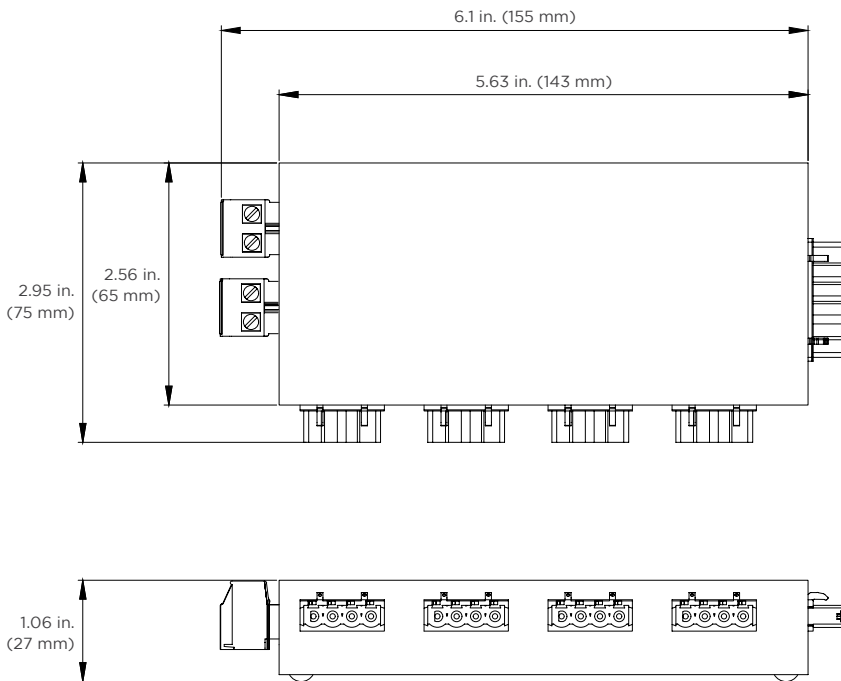
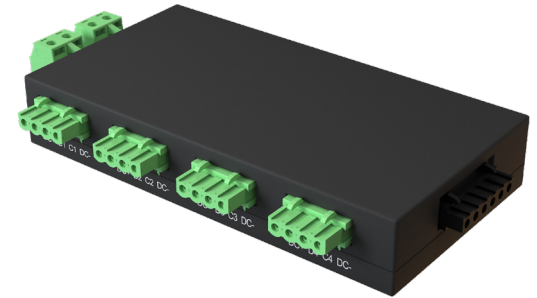

CONNECTIONS

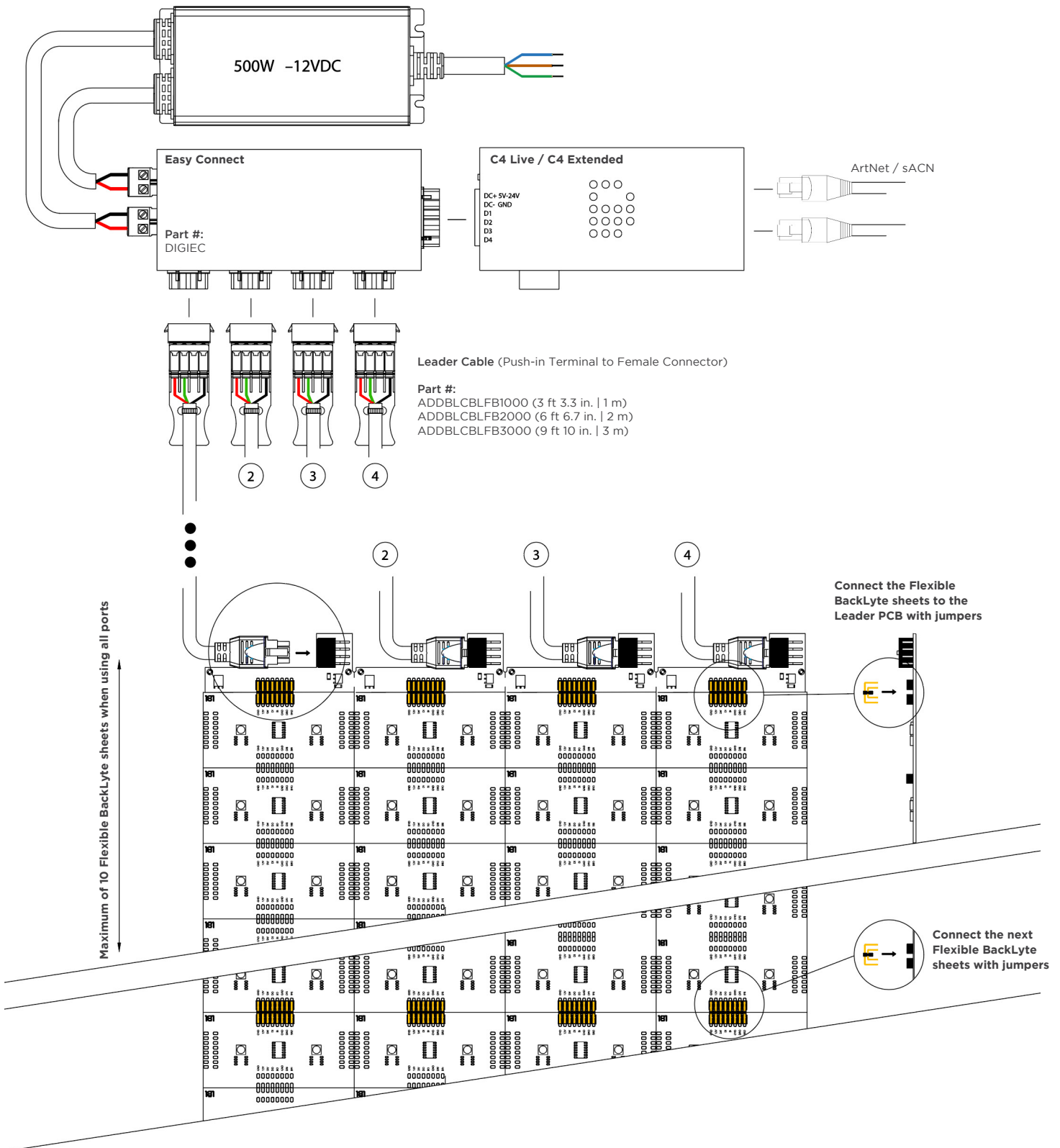



CONNECTION EXAMPLES

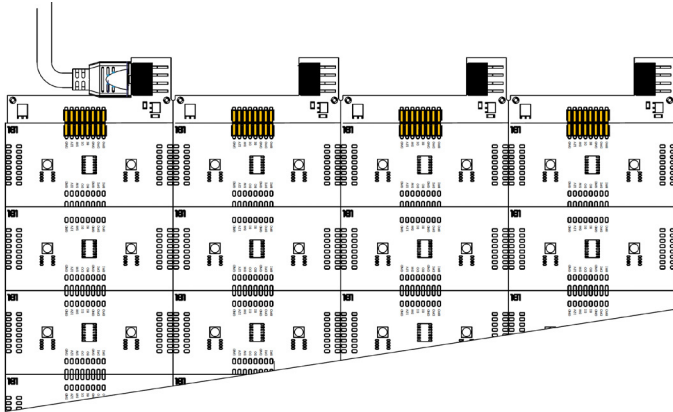

Max 240 pixels when using 1 input cable

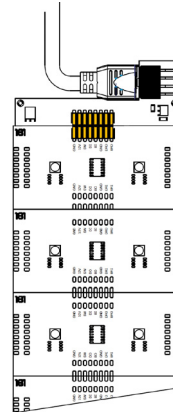

Max 240 pixels when using 1 input cable

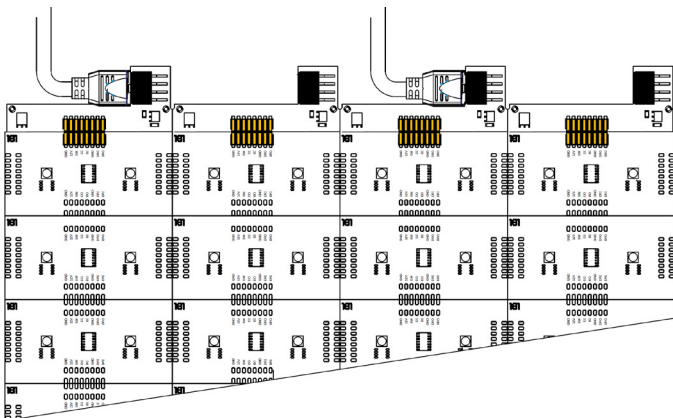

Max 480 pixels when using 2 input cables

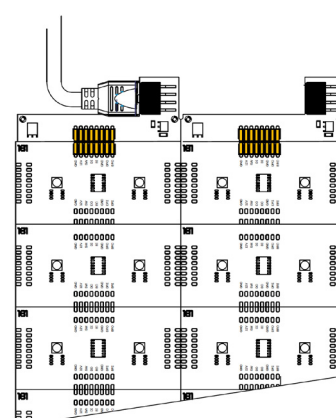

Max 240 pixels when using 1 input cable

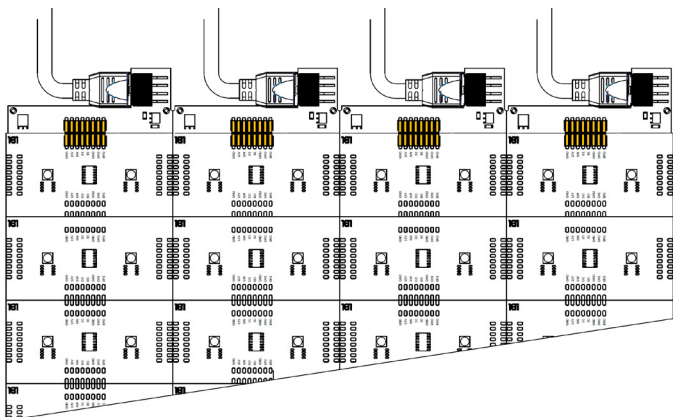

Max 960 pixels when using 4 input cables

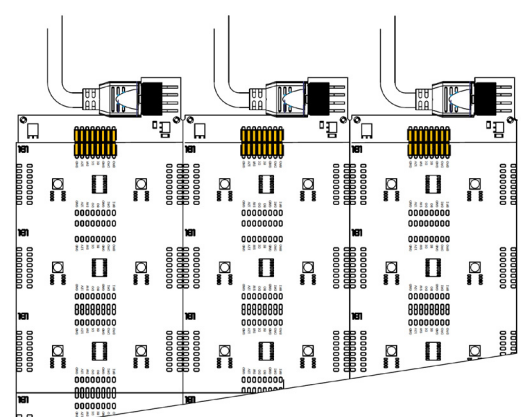

Max 720 pixels when using 3 input cables