

| | |
|-------|---------|
| Date | Project |
| Notes | |

FLEXIBLE BACKLYTE ADDRESSABLE SHEET

The Flexible BackLyte Addressable Sheet lets you program and control individual pixels for precision lighting effects. Each 12.6 x 18.9 in. (320 x 480 mm) sheet includes 96 RGB pixels. The sheet is only 0.08 in. (2 mm) thick. Trim, bend and daisy chain each Flexible BackLyte Addressable Sheet to create custom shapes. Cut around any obstacles! Use with incredibly simple SPI (Serial Peripheral Interface) controls for amazing color changing effects.

- Flexible 12.6 x 18.9 in. (320 x 480 mm) sheet
- 48 cuttable rectangles
- 624 lm/sheet (all on)
- 96 RGB pixels per sheet spaced at 1.6 in. (40 mm)
- Program each individual LED pixel
- Uses SPI controls
- 8 in. (200 mm) min. bending diameter (width)
- 4 in. (100 mm) min. bending diameter (length)
- 12V
- Daisy chain up to 10 full sheets with jumpers
- IP20 for indoor use
- 5-year warranty

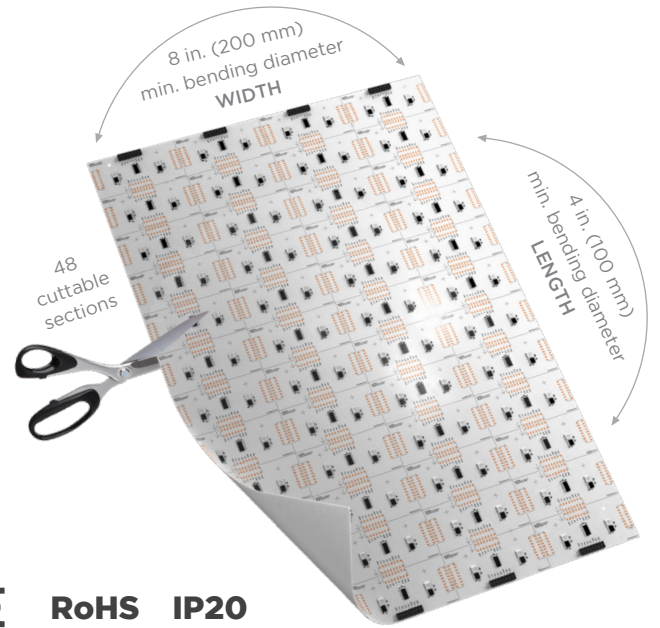

ORDERING GUIDE

| Category | Voltage | IP Rating | Wattage | Color or Color Temperature |
|--|-------------|-----------|-----------|----------------------------|
| FBLADD | 12 | 20 | 24 | RGB |
| FBLADD - Flexible Backlyte Addressable | 12 - 12V DC | 20 - IP20 | 24 - 24 W | RGB - Red, Green, Blue |

AVAILABLE COLORS



RGB

ACCESSORIES:

- | | | |
|--|---|---|
| <ol style="list-style-type: none"> Jumper ADDBLJUMP Lead PCB ADDBLHEADER | <ol style="list-style-type: none"> Lead Cable ADDBLCBLFB1000 (3 ft 3.3 in. 1 m) ADDBLCBLFB2000 (6 ft 6.7 in. 2 m) ADDBLCBLFB3000 (9 ft 10 in. 3 m) | <ol style="list-style-type: none"> Easy Connect DIGIEC |
|--|---|---|

SPECIFICATIONS

| | |
|-----------------------|---|
| Operating Voltage | 12V DC |
| Power Consumption | 24 W |
| IC Code | 16-bit (Default) GS8208 |
| Luminous Efficacy | 26 lm/W |
| Beam Angle | 120° |
| LEDs per sheet | 96 |
| LED spacing | 1.57 in. (40 mm) |
| Pixels per fixture | 96 |
| Color Temperature | RGB |
| Luminous Flux | 624 lm per sheet |
| Minimum Bend Diameter | Length: 4 in. (100 mm) Width: 8 in. (200 mm) |
| Protection Rating | IP20 |
| Storage Temperature | -40° F to 176° (-40° C to 80° C) |
| Operating Temperature | -22° F to 140° (-30° C to 60° C) |
| Lamp Life | 50,000 Hours |
| Dimensions (LxWxH) | 18.89 x 12.59 x 0.078 in. (480 x 320 x 2 mm) |
| Warranty | 5 Years |

Acolyte does not warrant or represent that the information is free from errors or omission. The information may change without notice and Acolyte is not in any way liable for the accuracy of any information printed and stored or in any way interpreted or used.

DIMENSIONS

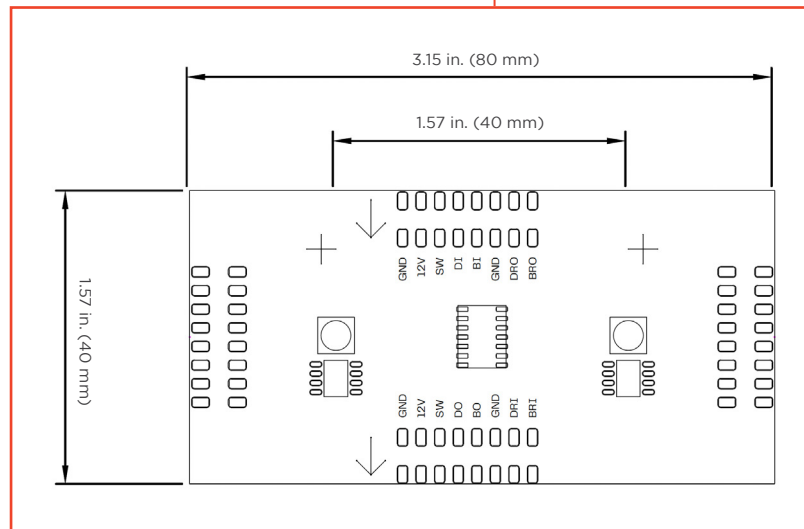
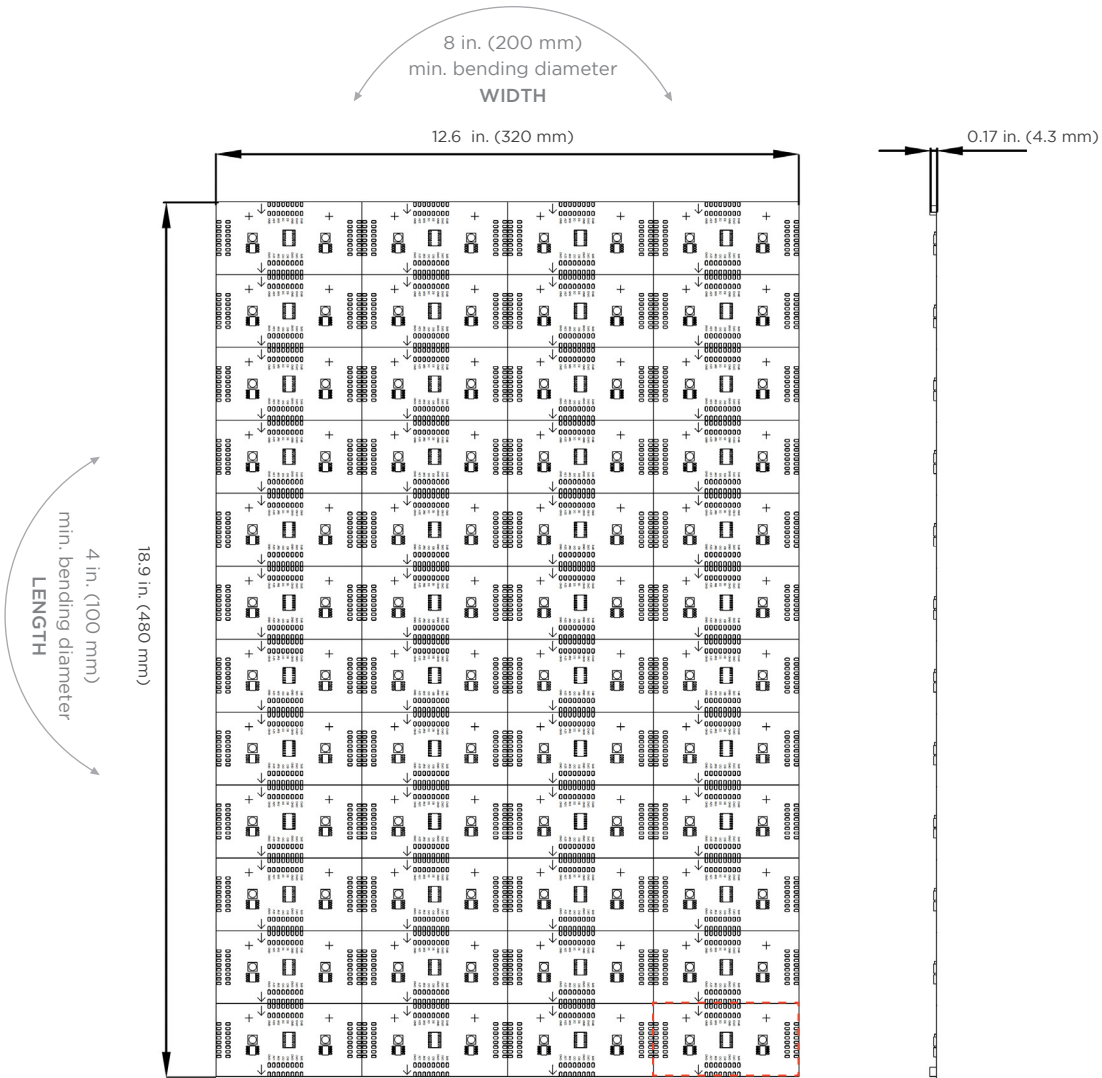

LEADER PCB

Part #: ADDBLHEADER

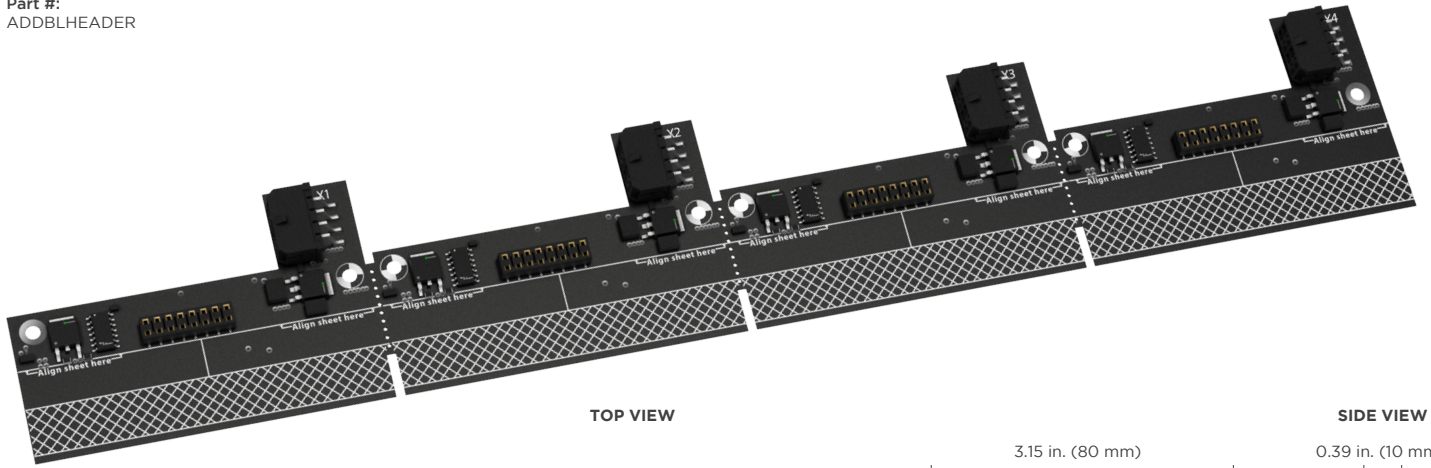

TOP VIEW

SIDE VIEW

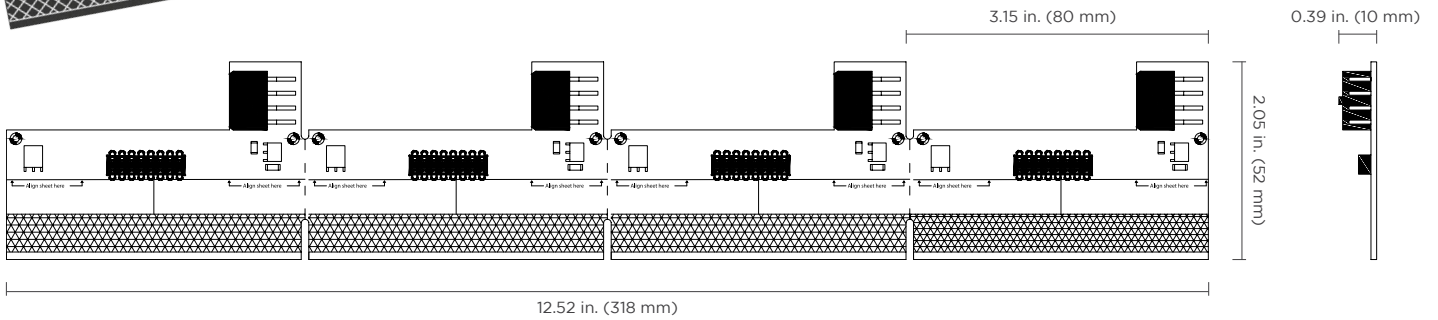

JUMPER

Part #: ADDBLJUMP



TOP VIEW

SIDE VIEW

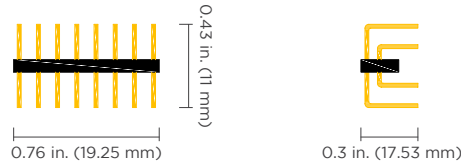

ASSEMBLED VIEW

Flexible BackLyte Addressable Sheet

Leader PCB

Jumper

Connect Flexible BackLyte Addressable Sheet to the Leader PCB with jumpers

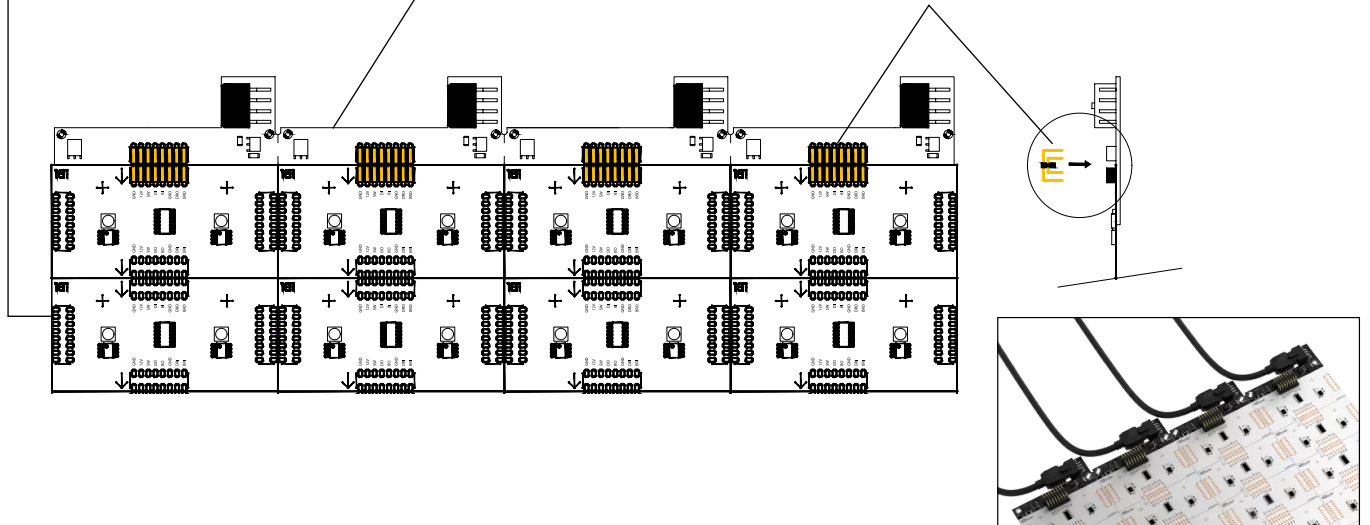

LEADER CABLE (PUSH-IN TERMINAL TO FEMALE CONNECTOR)

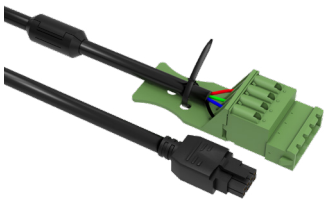

Part #:
 ADDBLCBLFB1000 (3 ft 3.3 in. | 1 m)
 ADDBLCBLFB2000 (6 ft 6.7 in. | 2 m)
 ADDBLCBLFB3000 (9 ft 10 in. | 3 m)

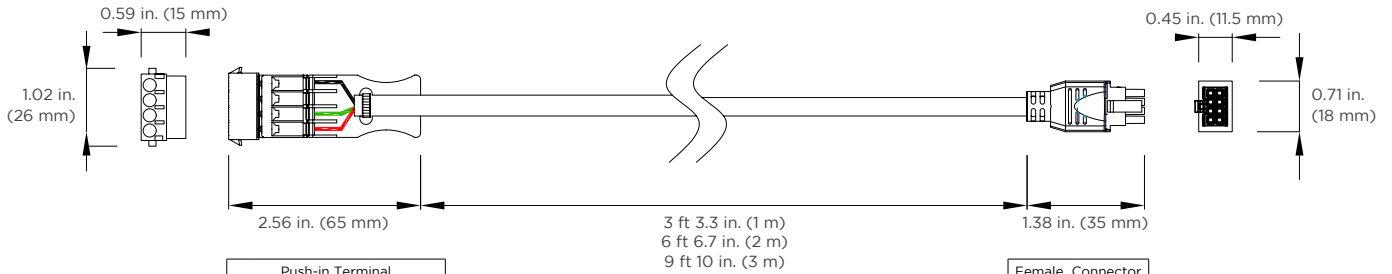

| Push-in Terminal | | |
|------------------|----------|----------|
| 1 | Red | V + |
| 2 | Green | Data |
| 3 | Not used | Not used |
| 4 | Black | GND |

| Female Connector | |
|------------------|------|
| 1 | V + |
| 2 | V + |
| 3 | V + |
| 4 | V + |
| 5 | Data |
| 6 | GND |
| 7 | GND |
| 8 | GND |

EASY CONNECT

Easy Connect is a plug and play connector that joins your C4 controller and power supply with your LEDs. No complex wiring required. Connect your power supply on one side and the input cable on the other.

Part #:
DIGIEC

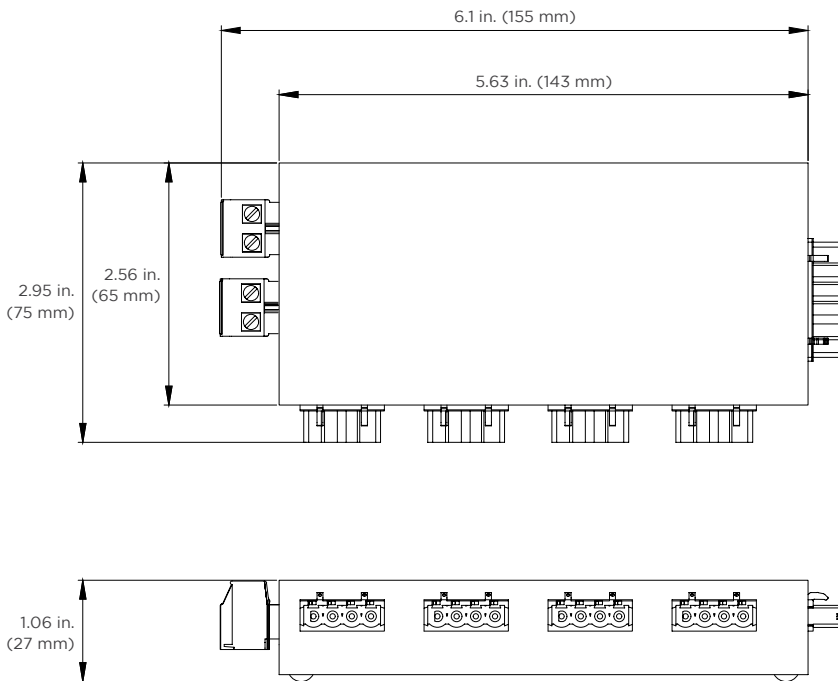
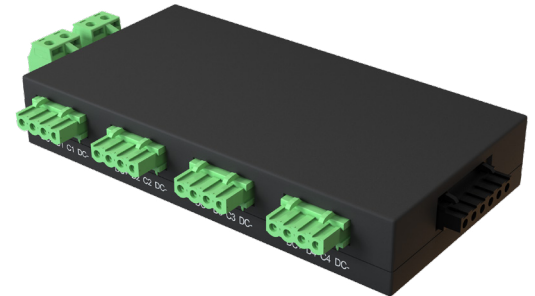

CONNECTIONS

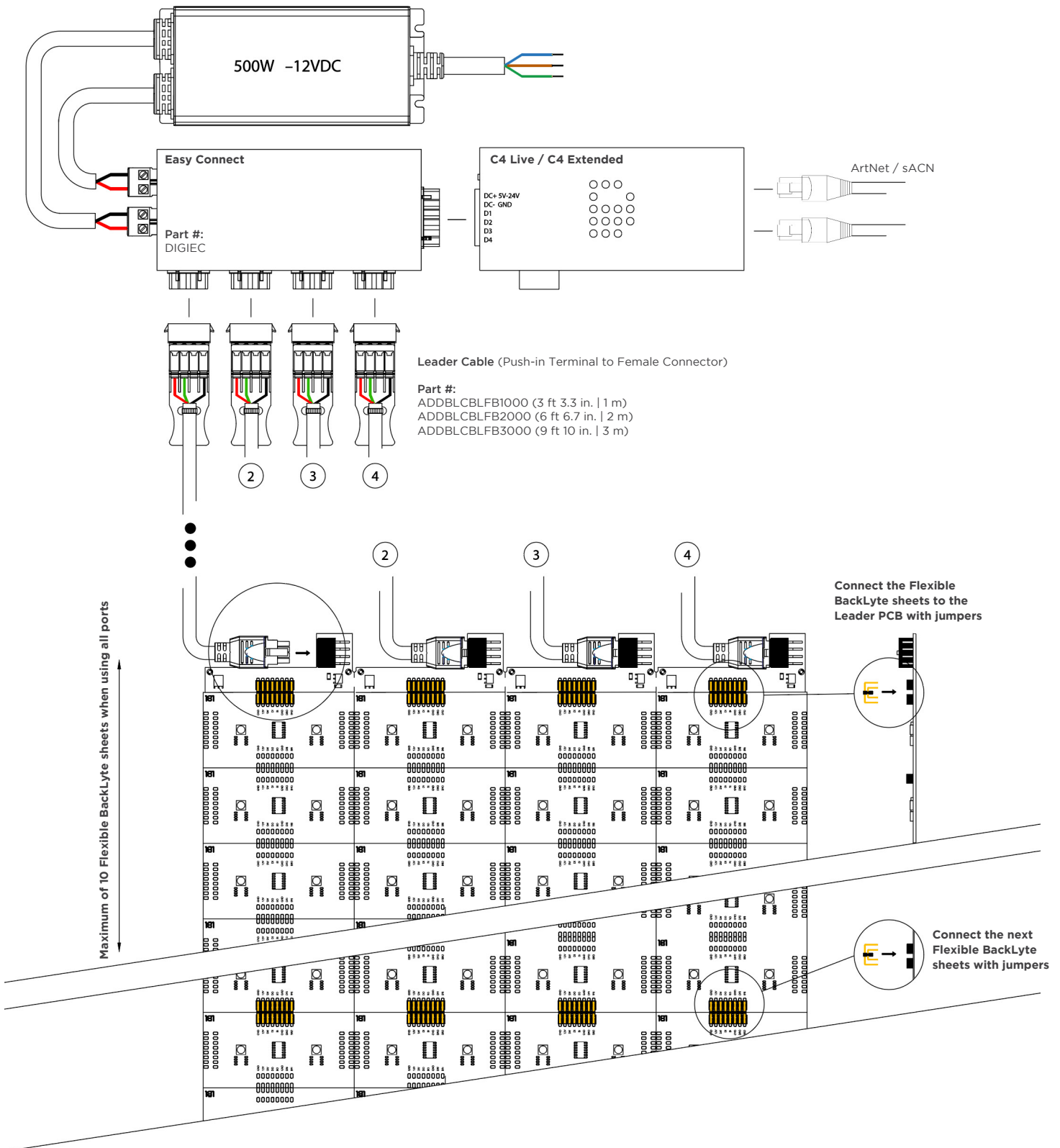

CONNECTION EXAMPLES

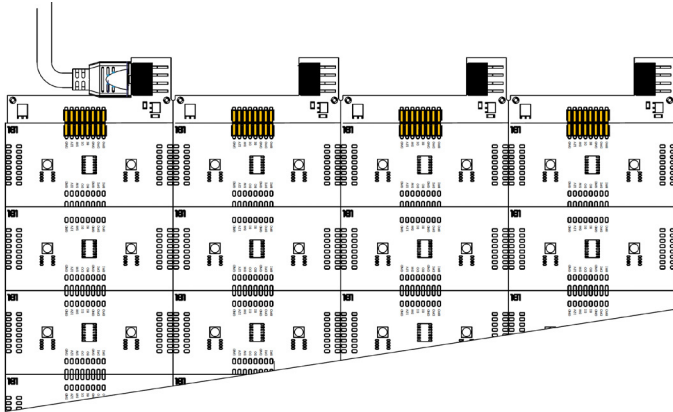

Max 240 pixels when using 1 input cable

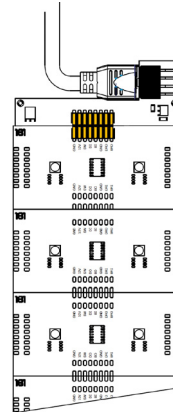

Max 240 pixels when using 1 input cable

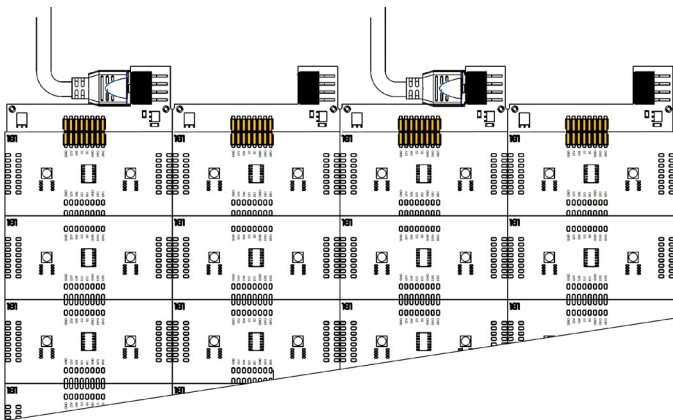

Max 480 pixels when using 2 input cables

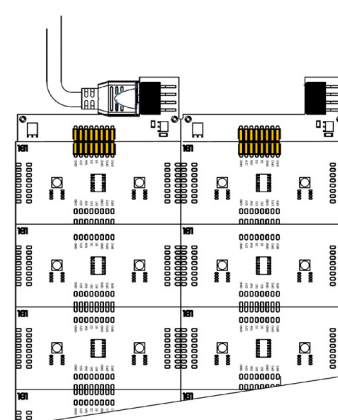

Max 240 pixels when using 1 input cable

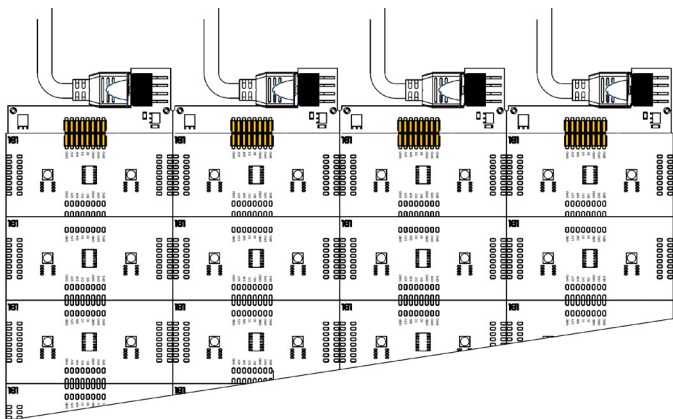

Max 960 pixels when using 4 input cables

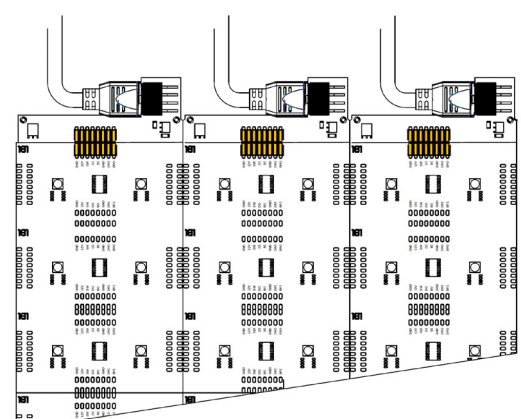

Max 720 pixels when using 3 input cables