

**4 ZONE SINGLE COLOR RF REMOTE**

The AgiLight 4 Zone Single Color RF Remote is a remote dimmer controller which offers both switch and dimming functions. Designed with a touch color wheel, this remote offers smooth dimming without any flickering lights.

- 4 Zone
- 3 Scenes
- Control distance up to 100 feet (30 meters)
- Save 3 scenes for each zone

**Applications:**

Commercial	Hospitality	Residential
Entertainment	Museums	Retail
Healthcare	Public Spaces	



**Dimensions**

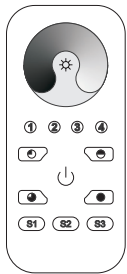

**Width:** 2.17 in (55 mm)  
**Length:** 4.72 in (120 mm)  
**Depth:** 0.67 in (17 mm)

**ORDERING GUIDE**

STANDARD

Category

**RFREMOTESW4Z**

**RFREMOTESW4Z** - 4 Zone Single Color RF Remote

**Note:** This remote requires pairing with AgiLight 4 Channel RF Interface. Part number: RFINTERFACE4CH. Each remote can control endless 4 Channel RF Interfaces, while each Interface can be controlled by up to 8 different remotes.

AgiLight does not warrant or represent that the information is free from errors or omission. The information may change without notice and AgiLight is not in any way liable for the accuracy of any information printed and stored or in any way interpreted or used.

REV.14JAN2025

**GLOBAL HQ**

320 Murray Hill Pkwy  
 East Rutherford, NJ 07073  
 U.S.  
 T: (+1) 212 629 6830  
 E: Sales-US@GENLEDBrands.com

**EUROPEAN HQ**

Hogeweyselaan 119  
 1382 JK Weesp  
 Netherlands  
 T: (+31) 346 235 000  
 E: SalesEurope@GENLEDBrands.com

**MEINA HQ**

PO Box 371378, #823, Building 4EA  
 Dubai Airport Free Zone  
 Dubai, UAE  
 T: (+971) 4 701 7901  
 E: SalesMEINA@genlebrands.com

**ASIA-PACIFIC HQ**

Room 402, Building D  
 Shenshi Tongchuang Science and Technology Park  
 No. 16 Hongyin Road  
 Xingqiang Community, Xihu Street  
 Guangming District, Shenzhen, China 518107  
 Sales: (+86) 139 1836 3905  
 Office: (+86) 755 8529 0710  
 E: Sales-Pacific@GENLEDBrands.com

### INSTRUCTIONS

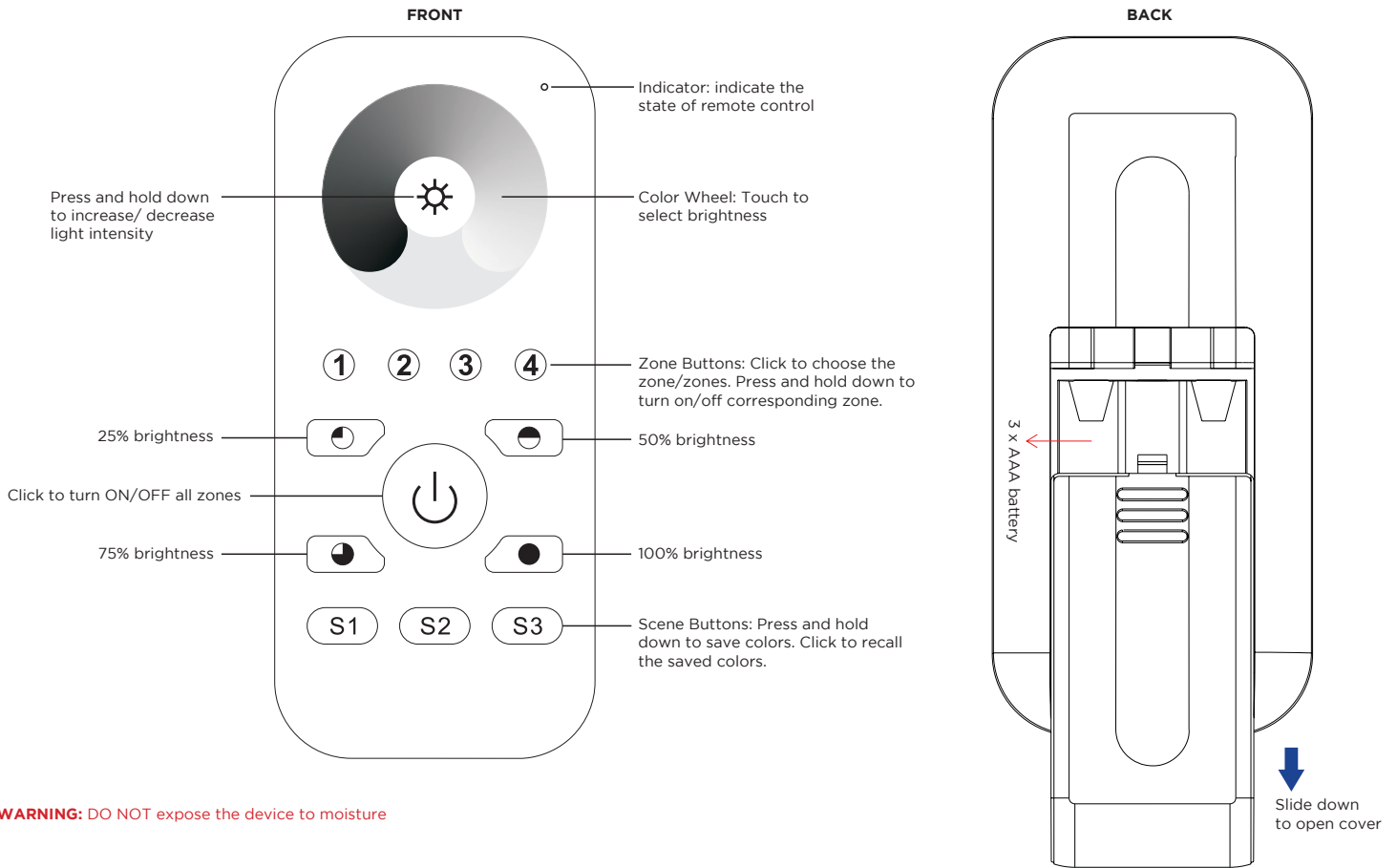

**WARNING: DO NOT** expose the device to moisture

#### PAIRING WITH RF INTERFACE

##### Method 1

- Step 1: Wire the RF Interface by following the wiring diagram listed on RF Interface spec sheet (<https://www.genledbrands.com/agilight/product/4-channel-rf-interface>).
- Step 2: Click ON/OFF button on RF Remote to activate the remote.
- Step 3: Click the "Learning Key" button on the RF Interface to set it into pairing mode.
- Step 4: Choose and click a zone number on the RF Remote.
- Step 5: Touch the color wheel on the RF Remote. If the LED module(s) connected with the RF Interface flicker(s) once, it means the RF Interface is paired with selected zone successfully.

##### Method 2

- Step 1: Wire the RF Interface by following the wiring diagram listed on RF Interface spec sheet (<https://www.genledbrands.com/agilight/product/4-channel-rf-interface>).
- Step 2: Click ON/OFF button on RF Remote to activate the remote.
- Step 3: Power off and power on the RF Interface.
- Step 4: Choose and click twice on a zone number on the remote (e.g. zone 4), then press and hold it down. If the LED module(s) connected with the RF Interface flicker(s) once within 10 seconds, it means the RF Interface is paired with selected zone successfully.

#### SAVING COLOR/SCENE/MODE

- Step 1: Click ON/OFF button on RF Remote to activate the remote.
- Step 2: Choose and click one or multiple paired zone numbers (e.g. zone 4).
- Step 3: Touch the color wheel to select the desired scene.
- Step 4: Press and hold any scene button (S1, S2, S3) on the remote. If the LED module(s) connected with the RF receiver flicker(s) once, it means the color/scene was saved successfully.

#### TO RECALL SAVED COLOR/SCENES

- Step 1: Click ON/OFF button on RF Remote to activate the remote.
- Step 2: Choose and click one or multiple paired zone numbers.
- Step 3: Press any scene button (S1, S2, S3) on the remote to recall the saved scene.

#### IF USING MULTIPLE RF INTERFACES

##### Option 1

Set all RF Interfaces in the same zone

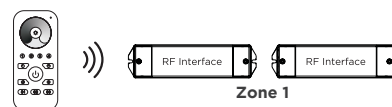

##### Option 2

Set each RF Interface in a different zone

