

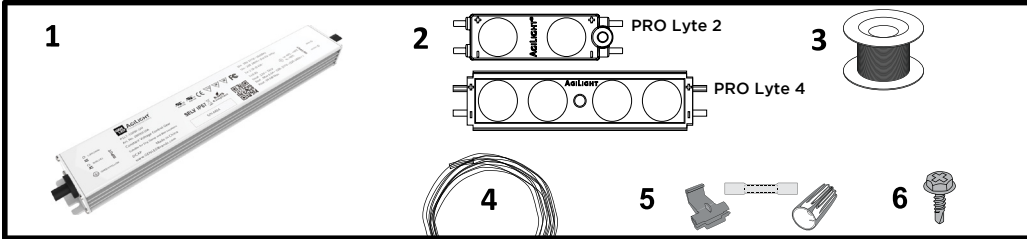

Read instructions completely before installation.
Altering the product in any way VOIDS the warranty.

Components



1. AgiLight PS-100W-GN power supply
2. 24V AgiLight PRO Lyte 2 and PRO Lyte 4 LED Modules
3. Minimum 18 AWG (0.82 mm) wire (UL Listed)
*Under certain conditions, a heavier gauge wire may be necessary.
4. PLTC Cable (UL Listed)
5. 22-14 AWG (0.33-2.08 mm) wire connectors or 22-18 AWG (0.33-0.82 mm) wire nuts, IDC, or butt splice connectors (UL Listed)
6. #6 or #8 (M3 or M4) screws

Tools

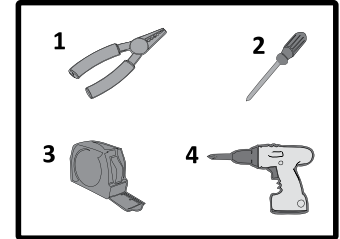

1. Wire Strippers
2. Screw Driver
3. Tape Measurer
4. Drill with inch bit



IP67

LED Module Installation

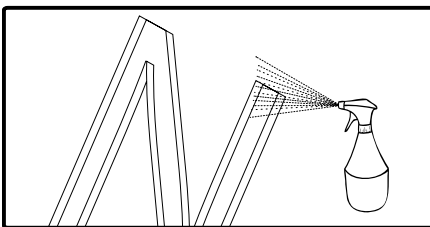

1. Clean inside of the sign with denatured alcohol. Allow alcohol to dry before proceeding.

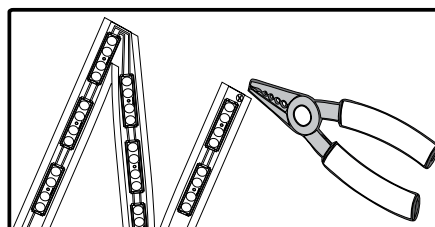

2. Place LED modules in the sign according to AgiLight layout or Population Density Guide. Cut product accordingly. (Product may be cut in between modules.)

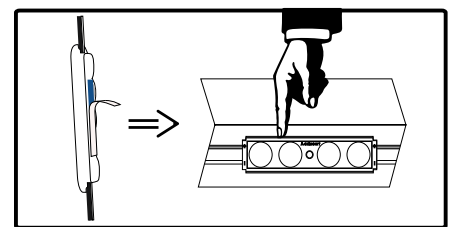

3. To adhere the LED module to the sign's back panel, remove liner from tape and firmly press the module in place. Repeat process for the rest of the layout.

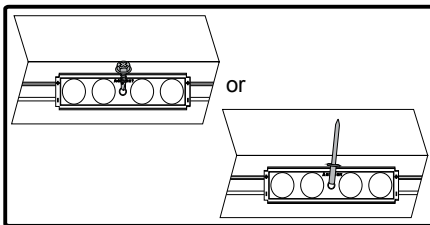

4. (Optional) Mechanically fasten the LED modules to the sign's back panel with screws or rivets. Use #6 (M3) or #8 (M4) metal screws or 1/8 inch (3.2 mm) rivets.

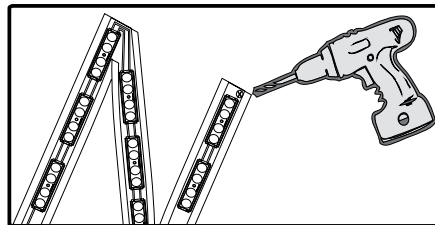

5. Drill a hole near the beginning of the string of LED modules and fit with an insulator for feeding power supply wire to the modules. Access hole should be approx. 0.25 in. (6.4 mm) in diameter, minimum.

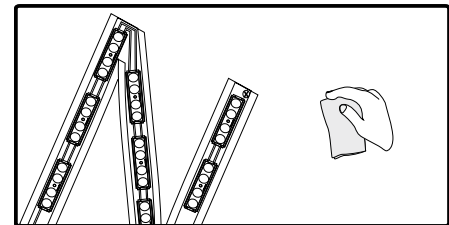

6. Remove debris and clean the inside of channel.

WARNING: READ BEFORE WIRING

1. Must use AgiLight Class 1 power supply rated for 12 Volts DC or less; proper wire gauge to connect to LED modules.
2. Check polarity for DC standard, BLACK (-) to BLACK (-) and RED (+) to RED, BLUE or WHITE (+).
3. UL 48 Standard requires spacing between power supplies to be at least 1 inch (25.4 mm) from end to end AND 4 inches (101.6 mm) from side to side.
4. Do not overload power supply and do not use products in submersed applications.
5. Grounding and bonding of the LED power supply must be done in accordance with National Electric Code (NEC) Article 600.
6. Follow all National Electric Codes (NEC) and local codes.

Wiring Instructions

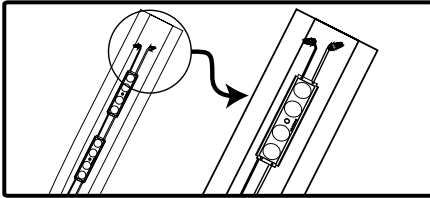

1. Use appropriate wire connectors to cover the ends of exposed wires not being used as a connection point.

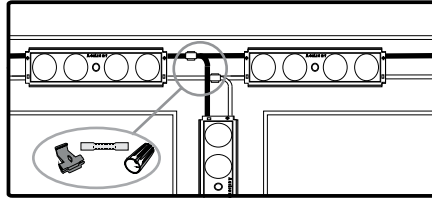

2. To connect (splice) wires, use an in-line (IDC) connector, butt splice connector or a twist-on wire connector.

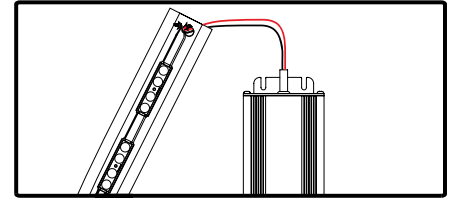

3. Connect the power supply to the product via the access hole in the sign's back.

Power Supply Wiring Instructions

<p>AC INPUT (3*AWG #18)</p> <p>Brown=Ground Blue=Neutral Yellow/green=Line</p>	<p>WARNING</p> <p>RISK OF ELECTRICAL SHOCK Turn OFF power before performing any maintenance.</p>	<p>DC OUTPUT (2*AWG #18)</p> <p>Red=Positive (+) Black=Negative(-)</p>
---	--	---

NOTE: 1. Have a licensed electrician make connections to primary (AC) input.
2. Per NEC 2008 Articles 725.121 through 725.130, secondary class 2 cables do not require conduit when installing.
3. Seal all wall penetrations with silicone to avoid intrusion of water.

Wiring Diagram

1. Single LED String: No Loop **DO NOT EXCEED** Maximum Single String in Modules = n

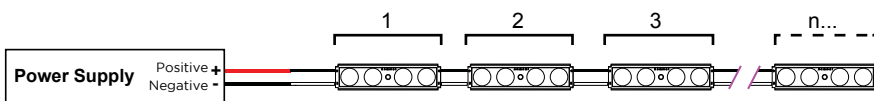

2. Multiple LED Strings: Parallel **DO NOT EXCEED** Maximum Single String in Modules = n

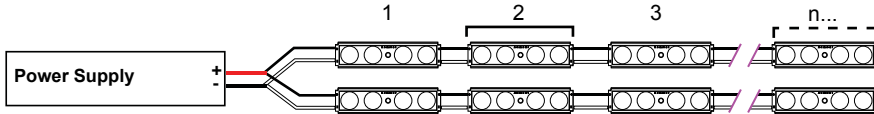

Power Supply	Wire Gauge	18 AWG 0.82 mm ²	16 AWG 1.32 mm ²	14 AWG 2.08 mm ²	12 AWG 3.31 mm ²
30W		36 ft / 10.97 m			
60W		18 ft / 5.4 m	29 ft / 8.8 m	46 ft / 14.02 m	74 ft / 22.55 m
100W		11 ft / 3.35 m	17 ft / 5.2 m	28 ft / 8.53 m	43 ft / 13.1 m
180W*		18 ft / 5.4 m**	29 ft / 8.8 m**	46 ft / 14.02 m**	74 ft / 22.55 m**

* 3 outputs

** 3 sets of modules at maximum listed distance

Troubleshooting

PROBLEM	POSSIBLE CAUSE
All LED modules are OFF or some of the LED modules are not illuminated.	1. Power supply may not be loaded properly with LED modules. 2. Wrong power supply. Must be 12VDC constant voltage. 3. Bad or loose connections.
Entire section does not light or lights intermittently.	1. Bad, loose, or improper connections. 2. Power supplies are spaced too close together; overheating. Note: Spacing between power supplies must be at least 1 inch (25.4 mm) from end to end AND 4 inches (101.6 mm) from side to side.
LED modules flicker or appear dim.	1. Power supply may not be properly loaded with LED modules. 2. Power supply may be damaged or defective. 3. Power supply may not be wired correctly. Check AC input wiring (Green to Ground, Black to Black, and White to White).