

**WARNING**

Disconnect power and remove ballast before installing assemblies.

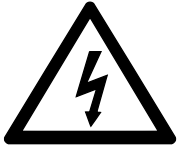

**ALERTE**

Déconnecter la puissance et enlever le ballast avant d'installer des assemblages.

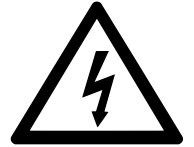

**NOTE:** We recommend using electrical insulating gloves

1. Turn OFF the circuit breaker supplying power to the sign.
2. Disconnect existing lighting system.
3. Be sure to cap off AC line wires before installing AgiLight power supply.

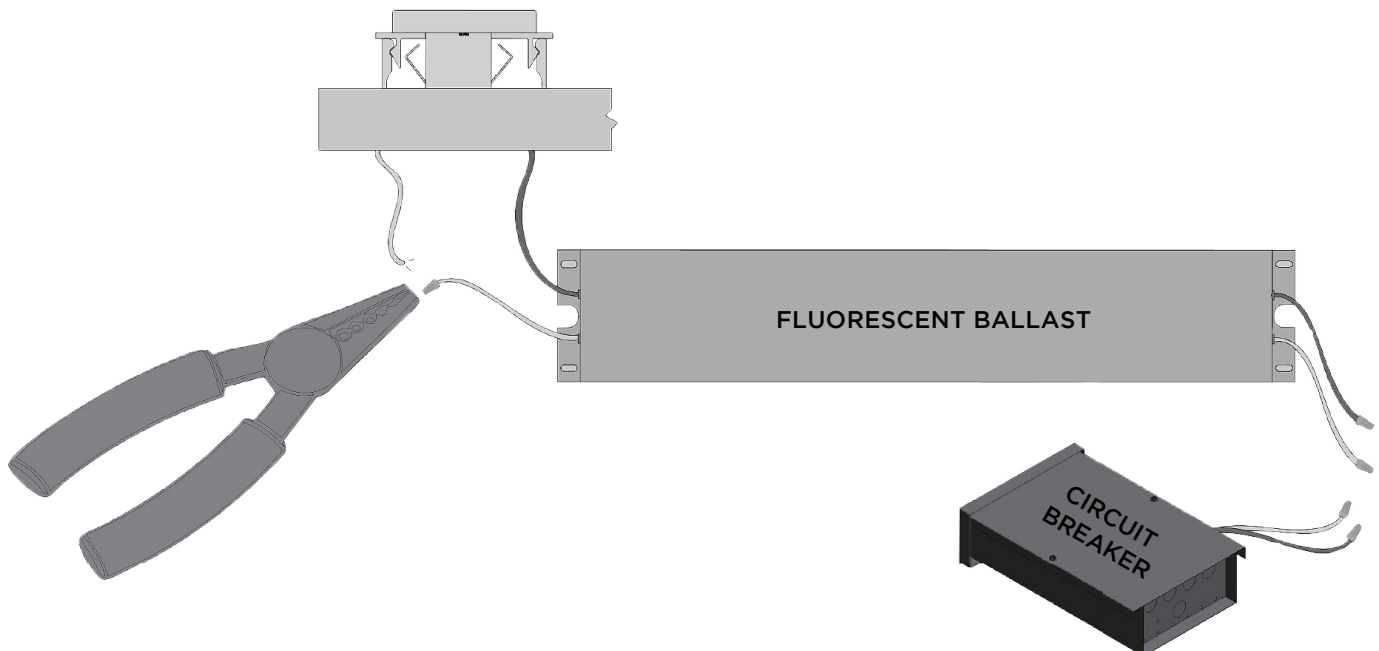

**READ INSTRUCTIONS COMPLETELY BEFORE INSTALLATION. ALTERING THE PRODUCT IN ANY WAY VOIDS THE WARRANTY.**



**WARNING:** RISK OF DEATH OR SERIOUS INJURY DUE TO ELECTRIC SHOCK.  
**AVERTISSEMENT :** RISQUE DE DÉCÈS OU DE BLESSURES GRAVES DUS À UN CHOC ÉLECTRIQUE.



**TOOLS NEEDED**

1. Wire Strippers
2. Screw Driver
3. Tape Measure
4. Drill
5. Gloves

1.

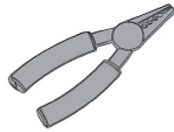

2.



3.

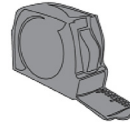

4.

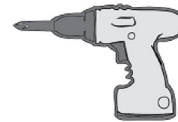

5.



**COMPONENTS**

1. 6500K Single-sided Module (LS-TLP-PL4-65K-347-SS)
2. 6500K Double-sided Module (LS-TLP-PL4-65K-347-DS)
3. Turnlock PRO Bar (LS-TLP-096-BAR)
4. Adjustable Mounting Bracket (LS-TLP-MNT)
5. HO End Cap (LS-TLP-CAP)
6. Coupler (LS-TLP-COUP)
7. M5 screws
8. M4 screws
9. AgiLight Class 2 Power Supply E354486 (see table right)

**Part Number**

**Description**

PS24-100W-GN	24V 100W Power Supply
PS24-30W-GN	24V 30W Power Supply
PS24-60W-GN	24V 60W Power Supply
PS24-300W-GN	24V 300W Power Supply



**IP67**

1.

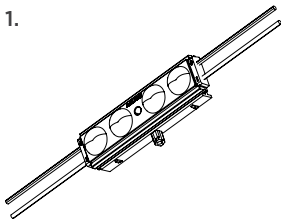

2.

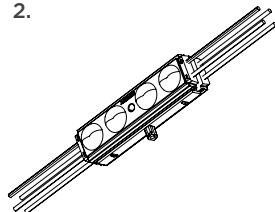

3.

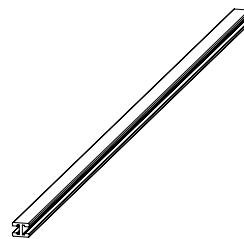

4.

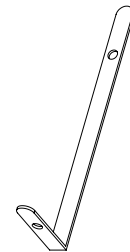

5.



6.



7.



8.



9.

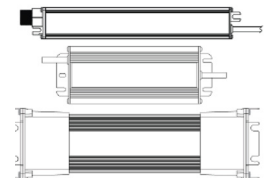

ONLY WORKS WITH T8 & T12 RDC SOCKETS

**INSTALLATION**

**NOTE:** a. You can either mount the Turnlock PRO Bar in a sign (between steps 1 and 2) and then add the modules OR attach the modules and then mount the Turnlock PRO Bar (between steps 6 and 7).  
b. When using single-sided modules, ensure that all modules face the intended (same) direction..

1. Measure Turnlock PRO Bar to determine desired length, number of modules and placement. Cut Turnlock PRO Bar to fit.\*

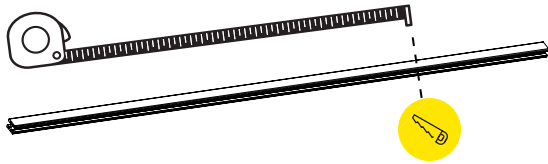

2. Align module so that it is perpendicular to Turnlock PRO Bar.

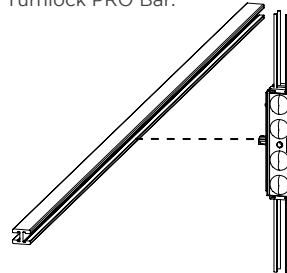

3. Push module fully into Turnlock PRO Bar.

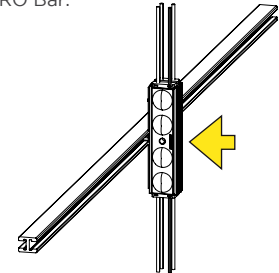

4. Rotate module clockwise until it locks into place, parallel with Turnlock PRO Bar.

To remove module, turn counterclockwise.

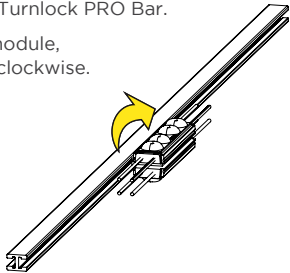

5. Move to the next module in the string and repeat.

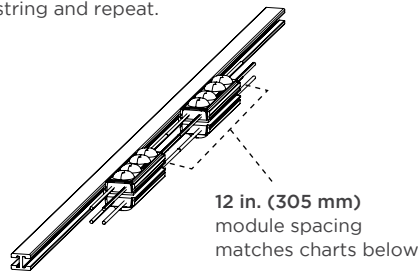

6. Cut wires to fit and cap end wires.

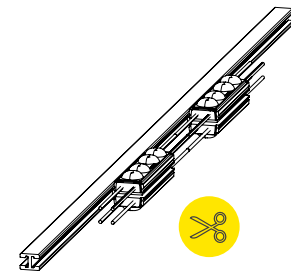

7. Daisy chain as needed and attach to power supply. Please reference Power Supply Loading table on page 2.



Up to **64** Single-sided Modules  
or  
Up to **32** Double-sided Modules

**MOUNTING INSTALLATION**

- 1.1 Slide accessory onto/ into bar.
- 1.2 Attach accessory to bar with M4 screw. Repeat on other end of bar.
- 1.3 Attach mounting bracket to sign with M5 screw.

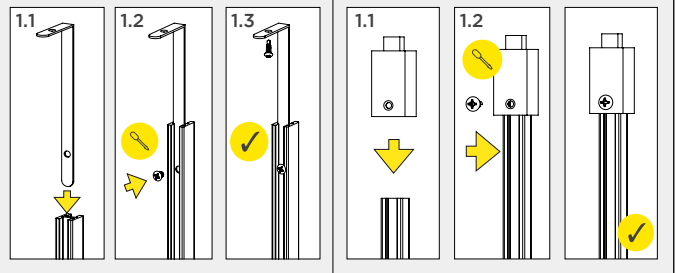

\* We recommend using End Caps to retrofit HO fixtures and Adjustable Mounting Brackets to retrofit one- or two-pin fixtures. The figures in this chart are for standard HO end cap fixtures. Installer should double-check lengths before cutting. AgiLight is not responsible for slight dimension variations.

Standard fluorescent lengths			Suggested # of modules per bar	Cut Turnlock PRO Bars to (then add end caps)	Standard fluorescent lengths			Suggested # of modules per bar	Cut Turnlock PRO Bars to (then add end caps)
F18T12	15.8 in. / 401 mm	2	15.1 in./383.5 mm	F15T8	17.2 in. / 438 mm	2	16.5 in. / 419 mm		
F24T12	21.8 in. / 554 mm	2	21.1 in./535.9 mm	F18T8	22.8 in. / 580 mm	2	22.1 in. / 561 mm		
F30T12	27.8 in. / 706 mm	3	27.1 in./688.3 mm	F30T8	33.8 in. / 859 mm	3	33.1 in. / 841 mm		
F36T12	33.8 in. / 858.5 mm	3	33.1 in./840.7 mm	F36T8	47.2 in. / 1200 mm	4	46.5 in. / 1181 mm		
F42T12	39.8 in. / 1011 mm	4	39.1 in./993.1 mm	F58T8	59.1 in. / 1500 mm	5	58.4 in. / 1483 mm		
F48T12	45.8 in. / 1163 mm	4	45.1 in./1145.5 mm	F70T8	69.4 in. / 1763 mm	6	68.7 in. 1745 mm		
F60T12	57.8 in. / 1468 mm	5	57.1 in./1450.3 mm						
F64T12	61.8 in. / 1570 mm	5	61.1 in./1551.9 mm	F14T5	21.6 in. / 549 mm	2	20.9 in. / 531 mm		
F72T12	69.8 in. / 1773 mm	6	69.1 in./1755.1 mm	F18T5	23.0 in. / 585 mm	2	22.3 in. / 566 mm		
F84T12	81.8 in. / 2078 mm	7	81.1 in./2059.9 mm	F21T5	33.4 in. / 849 mm	3	32.7 in. / 831 mm		
F96T12	93.8 in. / 2383 mm	8	*93.1 in./2364.7 mm	F28T5	45.2 in. / 1149 mm	4	44.5 in. / 1130 mm		
F108T12	105.8 in. / 2687 mm	9	**105.1 in./2669.5 mm	F32T5	47.0 in. / 1195 mm	4	46.3 in. / 1176 mm		
F117T12	114.8 in. / 2916 mm	10	**114.1 in./2898.1 mm	F35T5	57.0 in. / 1449 mm	5	56.3 in. / 1430 mm		
F120T12	117.8 in. / 2992 mm	10	**117.1 in./2974.3 mm						

\* full bar/no cut needed    \*\* 2 pieces with coupler

**WARNING: READ BEFORE WIRING**

1. Must use AgiLight® 24VDC power supply; proper wire gauge to connect to LED modules.
2. Check polarity for DC standard, BLACK (-) to BLACK (-) and RED (+) to RED (+).
3. UL 48 Standard requires spacing between power supplies be at least 1 inch (25.4mm) from end to end, and 4 inches (101.6mm) from side to side.
4. Do not overload power supply and do not use products in submersed applications.
5. Grounding and bonding of the LED power supply must be done in accordance with National Electric Code (NEC) Article 600.
6. Follow all National Electric Codes (NEC) and local codes.

**POWER SUPPLY WIRING INSTRUCTIONS**

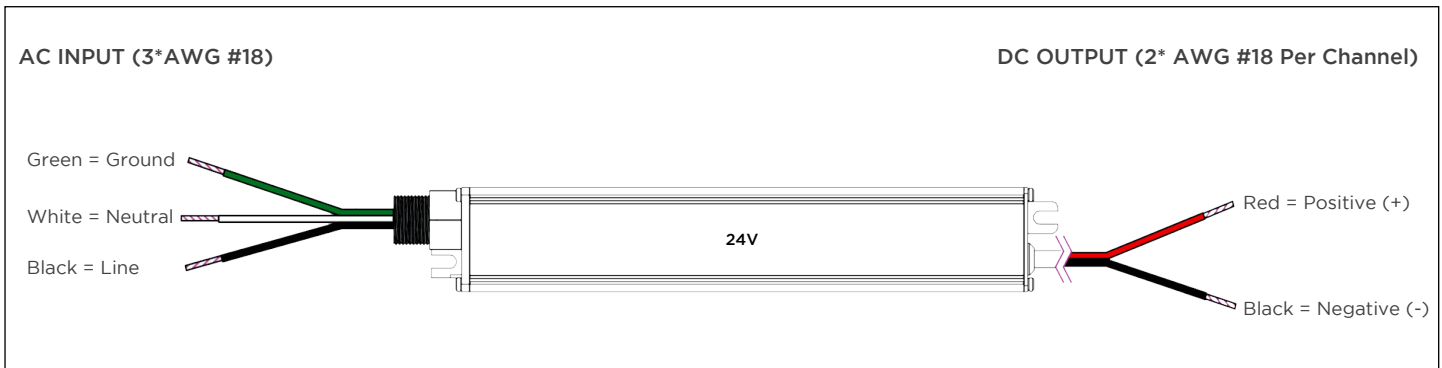

**TROUBLESHOOTING**

Problem	Possible Cause
All LED modules are OFF or some of the LED modules are not illuminated.	<ol style="list-style-type: none"> <li>1. Power supply may not be loaded.</li> <li>2. Wrong power supply. Must be 24V DC constant voltage.</li> <li>3. Bad or loose connections.</li> </ol>
Entire section does not light or lights intermittently.	<ol style="list-style-type: none"> <li>1. Bad, loose, or improper connections.</li> <li>2. Power supplies are spaced too close together; overheating.</li> </ol> <p><i>*Note: Spacings between LED power supplies shall be at least 1 inch (25.4mm) from end to end, and 4 inches (101.6mm) from side to side.</i></p>
LED modules flicker or appear dim.	<ol style="list-style-type: none"> <li>1. Power supply may not be properly loaded with LED modules.</li> <li>2. Power supply may be damaged or defective.</li> <li>3. Power supply may not be wired correctly. Check AC input wiring (Green to Ground, Black to Black, and White to White).</li> </ol>

**COMPONENTS**

1. Determine desired location for the transformer box.
2. Attach the box to the substrate. Screw through the middle and lower channels.  
(When used in a wet location, attach box\* to a substrate using screws with rubber gasketed heads.)

\* The transformer box is to be attached in all applications with 13/16" holes always facing down.

3. Using the maximum 1/2" long self-tapping screw, attach the power supply\* to the raised platform.

\* See power supply spec sheet for clearances.

4. The bottom of the box has 3 standard 13/16" diameter holes and 2 pilot holes for additional 13/16" holes.

5. Use the middle back 13/16" hole. Attach your metal conduit nipple from the safety disconnect switch box. It is important that the primary (120 VAC) wires be separated from the secondary (DC) circuit wires completely. Make all the 120 VAC splices in the safety disconnect box. No excess 120 VAC wiring should be in the transformer box.

\* Keep all secondary DC wiring as far away from the primary AC wiring as possible.

\*\* Remember that this location is a dry/damp area. Use the appropriate conduit and strain relief products.

6. Use the included #8 x 1/2" machine screw as the grounding lug. This lug can be attached to the box either with the threads and two Green nuts facing the inside of the box or so they face outside the box. The hole in the bottom of the box between the two 13/16" holes is for the attachment of the grounding lug. Attach the grounding wires from the LED letters to the box (if the grounding of the letters is required). Place the faceplate on the box, push up under the lip and secure with self-drilling screws to the box.

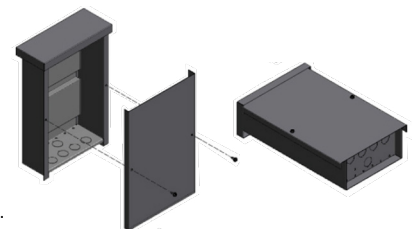

### WARNING

Item	Text
A.	<b>WARNING</b> - Risk of fire or electric shock. Turnlock PRO installation requires knowledge of sign electrical systems. If not qualified, do not attempt installation. Contact a qualified electrician.
B.	<b>WARNING</b> - Risk of fire or electric shock. Install this kit only in host signs that have been identified in the installation instructions and where the input rating of the Turnlock PRO does not exceed the input rating of the sign.
C.	<b>WARNING</b> - Risk of fire or electric shock. Installation of this Turnlock PRO may involve drilling or punching of holes into the structure of the sign. Check for enclosed wiring and components to avoid damage to wiring and electrical parts.
D.	Installer should examine all parts that are not intended to be replaced by the Turnlock PRO for damage and replace any damaged parts prior to installation of the Turnlock PRO.
E.	Installers should not disconnect existing wires from lampholder terminals to make new connections at lampholder terminals. Instead installers should cut existing lampholder leads away from the lampholder and make new electrical connections to lampholder lead wires by employing applicable connectors.
F.	<b>WARNING</b> - To prevent wiring damage or abrasion, do not expose wiring to edges of sheet metal or other sharp objects.
G.	Do not make or alter any open holes in an enclosure of wiring or electrical components during Turnlock PRO installation.
H.	Repair and seal any unused openings in the electrical enclosure. Openings greater than 12.7 mm (0.5 in.) diameter require a metal patch secured by screws or rivets and caulked with non-hardening caulk. Smaller openings may be sealed with non-hardening caulk.
I.	<b>WARNING:</b> To avoid potential fire or shock hazard, do not use this Turnlock PRO with existing shunted bi-pin lampholders in the host sign.  Note: Shunted lampholders are found only in fluorescent signs with Instant-Start ballasts. Instant-start ballasts can be identified by the words "Instant Start" or "I.S." marked on the ballast. This designation may be in the form of a statement pertaining to the ballast itself, or may be combined with the marking for the lamps with which the ballast is intended to be used, for example F40T12/IS. For more information, contact the Turnlock PRO manufacturer.
J.	"This sign has been modified to operate LED lamps. Do not attempt to install or operate * lamps in this sign" shall be marked on the retrofitted sign where readily visible by the user during normal maintenance including relamping. " * " shall be replaced by the original illumination type such as "fluorescent," "HID," etc. This marking shall be provided on a separate permanent label that is intended to remain in the applied position for the lifetime of the sign under conditions of normal use.  1. Markings that are within quotation marks shall be provided verbatim.

### AVERTISSEMENT

Article	Texte
A.	<b>AVERTISSEMENT</b> - Risque d'incendie ou de choc électrique. L'installation du kit d'adaptation LED nécessite la connaissance des systèmes électriques de signalisation. Si non qualifié, ne tentez pas l'installation. Contactez un électricien qualifié.
B.	<b>AVERTISSEMENT</b> - Risque d'incendie ou de choc électrique. Installez ce kit uniquement sur les panneaux d'hôte identifiés dans les instructions d'installation et dont les caractéristiques nominales d'entrée du kit de modification ne dépassent pas celles du panneau.
C.	<b>AVERTISSEMENT</b> - Risque d'incendie ou de choc électrique. L'installation de ce kit d'éclairage par LED peut impliquer de percer ou de creuser des trous dans la structure du panneau. Vérifier le câblage et les composants inclus pour éviter d'endommager le câblage et les pièces électriques.
D.	L'installateur doit examiner toutes les pièces qui ne sont pas destinées à être remplacées par le kit de rénovation pour rechercher des dommages éventuels et remplacer toutes les pièces endommagées avant l'installation du kit de modernisation.
E.	Les installateurs ne doivent pas déconnecter les fils existants des bornes de la douille pour effectuer de nouvelles connexions aux bornes de la douille. Les installateurs à la place doivent couper les supports de douille existants de celle-ci et établir de nouvelles connexions électriques avec les fils de la douille en utilisant les connecteurs appropriés.
F.	<b>AVERTISSEMENT</b> - Pour éviter tout dommage ou abrasion du câblage, ne l'exposez pas aux bords de la tôle ou d'autres objets coupants.
G.	"Ne faites ni ne modifiez les trous ouverts dans une enceinte de câblage ou de composants électriques pendant l'installation du kit."
H.	"Réparez et scellez toutes les ouvertures non utilisées du boîtier électrique. Les ouvertures de plus de 12,7 mm (1/2 po) de diamètre requièrent un patch métallique fixé par des vis ou des rivets et scellé avec du mastic non durcissant. Les petites ouvertures peuvent durcissement mastic."
I.	<b>AVERTISSEMENT:</b> pour éviter tout risque d'incendie ou d'électrocution, n'utilisez pas ce kit d'adaptation avec les douilles de lampe à deux broches shuntées existantes du panneau de contrôle hôte.  Remarque: les supports de lampe shuntés ne se trouvent que dans les enseignes fluorescentes équipées de ballasts à démarrage instantané. Les ballasts à démarrage instantané peuvent être identifiés par les mots "Démarrage instantané" ou "I.S". marqué sur le ballast. Cette désignation peut prendre la forme d'une déclaration concernant le ballast lui-même ou être combinée avec le marquage des feux avec lesquels le ballast doit être utilisé, par exemple F40T12 / IS. Pour plus d'informations, contactez le fabricant du kit d'adaptation de LED.
J.	"Ce panneau a été modifié pour faire fonctionner des lampes à LED. N'essayez pas d'installer ou de faire fonctionner * les lampes de ce panneau" doit être marqué sur le panneau mis à niveau à un endroit facilement visible par l'utilisateur lors de l'entretien normal, y compris le changement de lampe. « * » doit être remplacé par le type d'éclairage d'origine tel que « fluorescent », « HID », etc. d'utilisation normale.  1. Les repères entre guillemets doivent être fournis textuellement.