

NANO FLEX RGBW

The Nano Flex RGBW is a large 24V color changing flexible silicone grazer tube. Nano Flex RGBW is available with warm or cool Static White CCTs (2700K or 4000K) for varied brightness. Program it by the pixel. Dual bending capabilities (side- and top-bending!) make it an amazing solution for complex color changing grazer applications hospitality, landscape and architectural settings. Choose from end, side or bottom power feed. Compatible with DMX controls.

- 7.6 W/ft (25 W/m)
- Pixel RGBW (2700K, 4000K)
- 355 lm/ft (1165 lm/m) all on
- Programmable pixels (9.84 in. | 250 mm)
- DMX controls
- 7 LEDs/ft (24 LEDs/m)
- 1.64 in. (41.67 mm) LED spacing
- 16 ft 4.85 in. (5 m) max. length (single feed)
- 5.9 in. (150 mm) minimum bending radius
- Beam angles: 25x25°, 30x30°, 40x40°, 50x50°, 25x50°, 45xAsymmetric 30°
- IP67 and IK07 ratings
- Available in white or black housing
- Use with mounting clip, mounting channel, curved mounting channel, tiltable stand



ORDERING GUIDE

Category	IP Rating	Wattage	Color Temperature	Beam Angles	Housing Color	Power Feed
NANOFLEX	67	7.6				
NANOFLEX - Nano Flex	67 - IP67	7.6 - 7.6 W/ft (25 W/m)	RGB27ADD - Pixel RGBW (2700K) RGB40ADD - Pixel RGBW (4000K)	25 - 25x25° 30 - 30x30° 40 - 40x40° 50 - 50x50° 2550 - 25x50° 45A30 - 45xAsymmetric 30°	WH - White BK - Black	B - Bottom Feed S - Side Feed E - End Feed

ACCESSORIES (see page 2 for details)

1. Mounting Clip

Recommended for curved applications
Part #: NANOFLEXCLIP

3. Curved Mounting Channel

Recommended for curved applications
Part #: NANOFLEXCHANNELS

2. Mounting Channel

Recommended for all straight run applications
Part #: NANOFLEXCHANNEL

4. Tiltable Stand

Use with mounting clips or mounting channels
Part #: NANOFLEXTILTSTAND

AVAILABLE COLORS



RGBW

AVAILABLE BEAM ANGLES

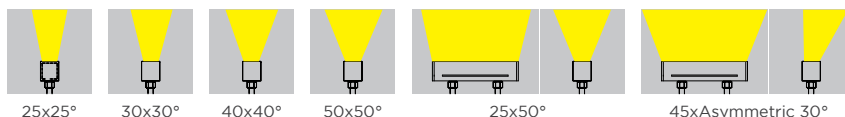

USAGE GUIDELINES

Nano Flex RGBW grazers cannot be cut in the field. All custom cuts and connections for these models must be performed at the factory to ensure waterproofing standards are met. Any modification of the waterproofing will result in a voided warranty.

Acolyte does not warrant or represent that the information is free from errors or omission. The information may change without notice and Acolyte is not in any way liable for the accuracy of any information printed and stored or in any way interpreted or used.

SPECIFICATIONS

Operating Voltage	24 VDC
Power Consumption	7.6 W/ft (25 W/m)
Protection Rating	IP67
Impact Rating	IK07
Colors	RGBW (2700K), RGBW (4000K)
LED Quantity	7 LEDs/ft (24 LEDs/m)
LED Spacing	1.64 in. (41.67 mm)
LEDs per Pixel	6
Lumens	Red: 59 lm/ft (195 lm/m), Green: 125 lm/ft (410 lm/m), Blue: 26 lm/ft (84 lm/m), White: 148 lm/ft (485 lm/m) All LEDs on: 355 lm/ft (1165 lm/m)
Beam Angle	25x25°, 30x30°, 40x40°, 50x50°, 25x50°, 45xAsymmetric 30°
Operating Temperature	-4 — 113 °F (-20 — 45 °C)
Max Run Length	16 ft 4.85 in. (5 m)
Incremental Length	9.84 in. (250 mm) NOT FIELD CUTTABLE
Minimum Bend Radius	5.9 in. (150 mm)
CRI (white)	80+ CRI for white channel
Lifetime (L70 reported)	50,000 hours
Warranty	5 years

MOUNTING ACCESSORIES

Part #: NANOFLEXCLIP



Length up to 39.4 in. (1 m)

Part #: NANOFLEXCHANNEL

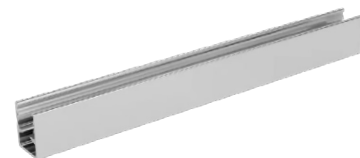

Front View

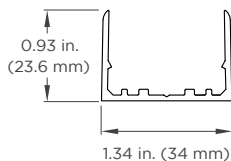

Top View

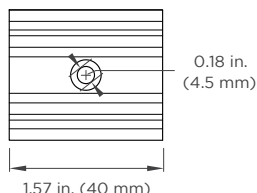

Front View

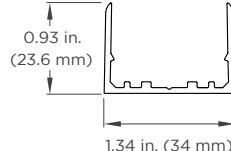

Top View

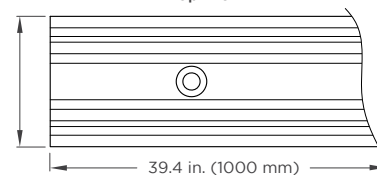

3. Curved Mounting Channel

Length up to 39.4 in. (1 m)

Part #: NANOFLEXCHANNELS

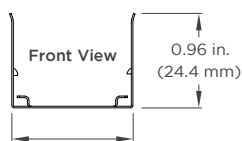

Side View

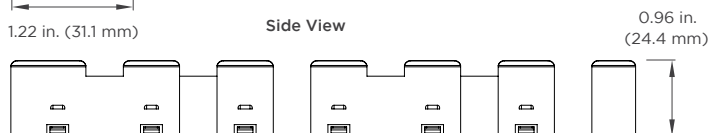

Top View

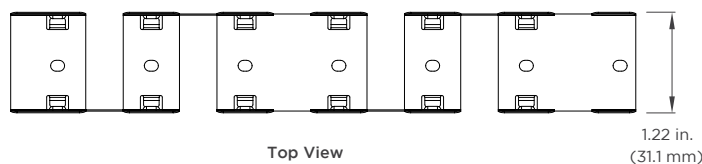

4. Tilttable Stand

Use with mounting clips or channels

Part #: NANOFLEXTILTSTAND

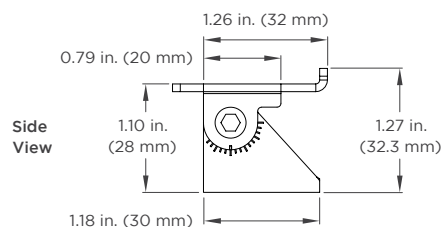

Top View

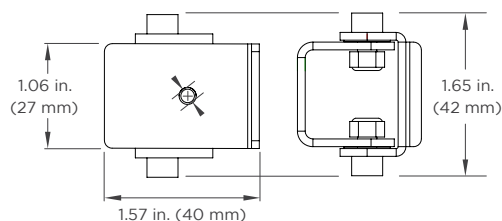

DIMENSIONS & POWER FEED OPTIONS

BOTTOM FEED (MOLDED END CAP)

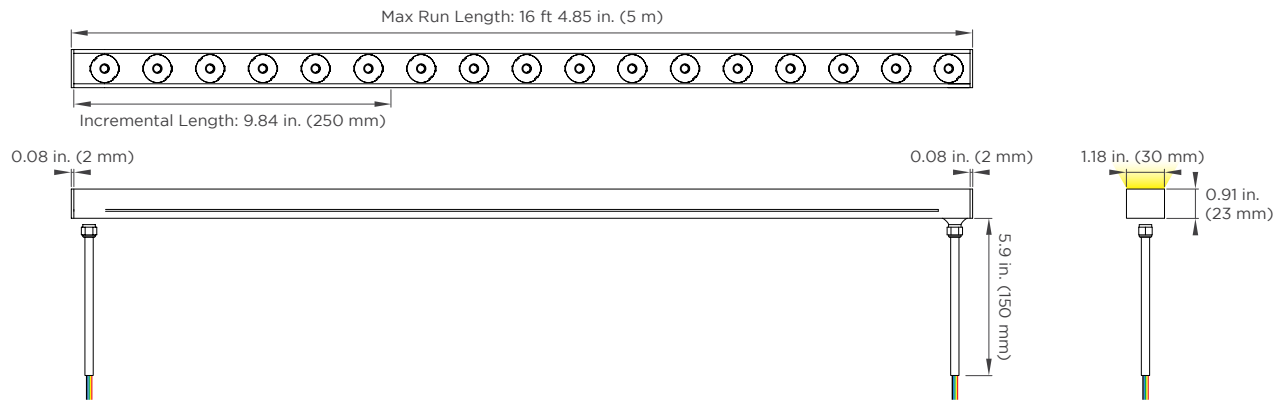

SIDE FEED WITH MOLDED END CAP

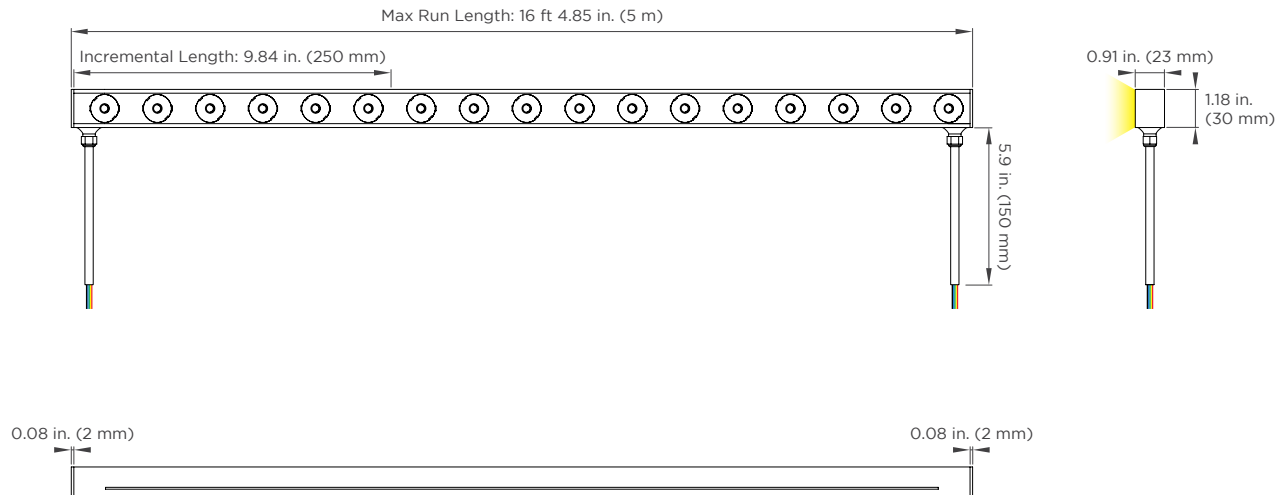

END FEED

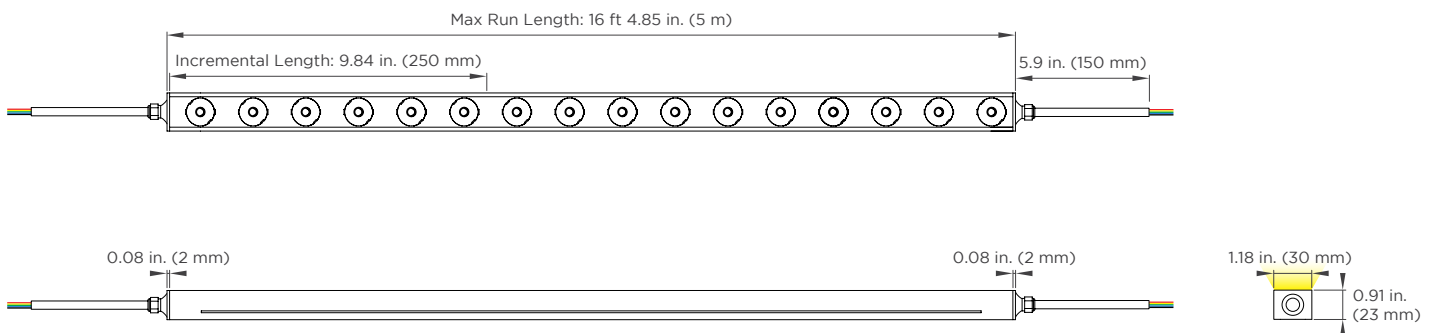

WIRING DIAGRAMS

One DMX Universe consists of 128 addresses and 512 channels (104.96 ft / 32 m of Nano Flex RGBW).

Any single run of Nano Flex that is less than 16 ft, 4.85 in. (5 m) can be wired directly to the controller.

For additional runs, Opto Splitter must be used. Each individual run will need its own Opto Splitter output.

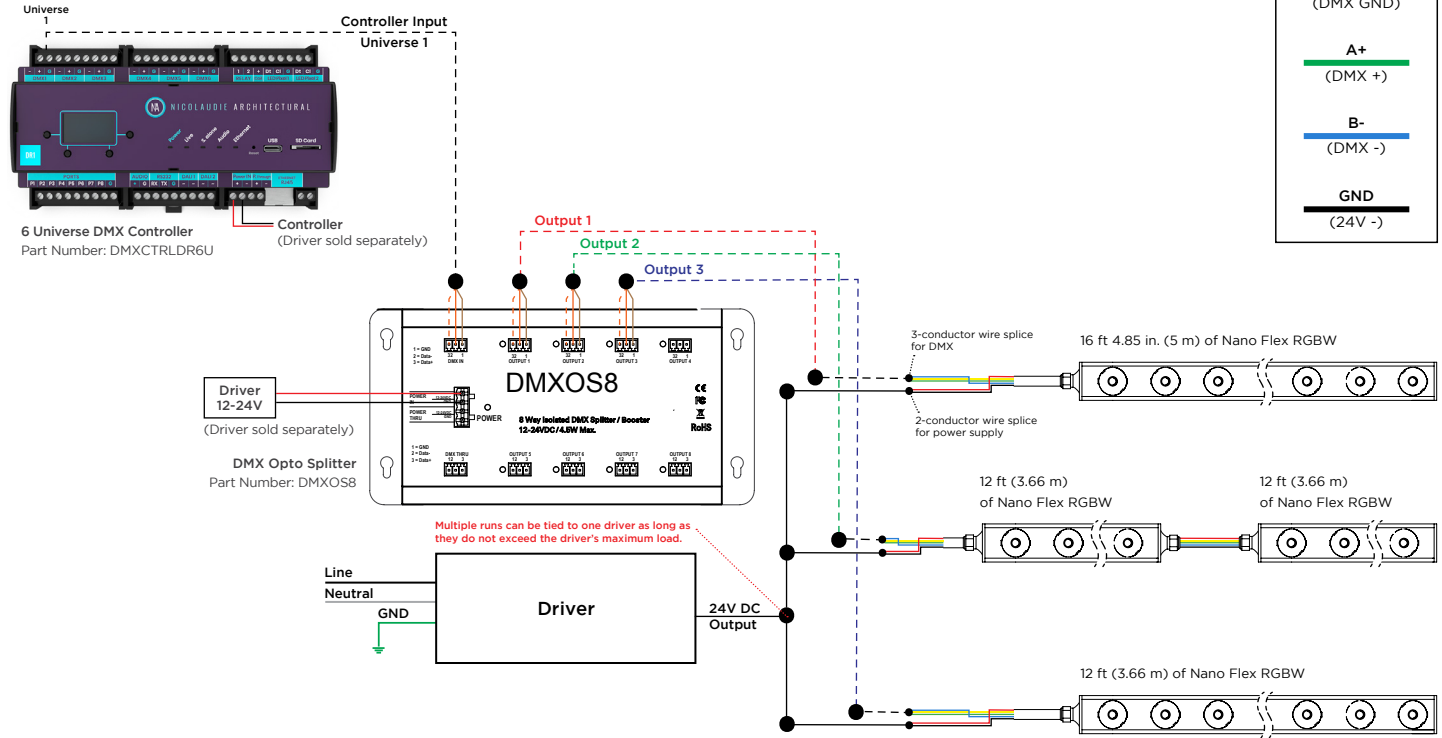

REV.15DEC2025

GLOBAL HQ

320 Murray Hill Pkwy
East Rutherford, NJ 07073
U.S.
T: (+1) 212 629 6830
E: Sales-US@GENLEDBrands.com

EUROPEAN HQ

Hogeweyselaan 119
1382 JK Weesp
Netherlands
T: (+31) 346 235 000
E: SalesEurope@GENLEDBrands.com

MEINA HQ

PO Box 371378, #823, Building 4EA
Dubai Airport Free Zone
Dubai, UAE
T: (+971) 4 701 7901
E: SalesMEINA@genledbrands.com

ASIA-PACIFIC HQ

Room 402, Building D
Shenshi Tongchuang Science and Technology Park
No. 16 Hongyin Road
Xingqiang Community, Xinhua Street
Guangming District, Shenzhen, China 518107
T: (+86) 755 8529 0710
E: Sales-Pacific@GENLEDBrands.com